

750071EJ

VW Tiguan
VW Tiguan Allspace

05/16 >>

08/17 >>



SCAN FOR
LATEST
INSTRUCTIONS

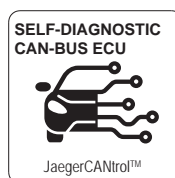
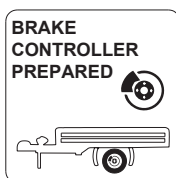
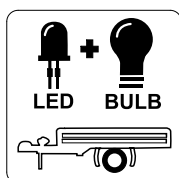
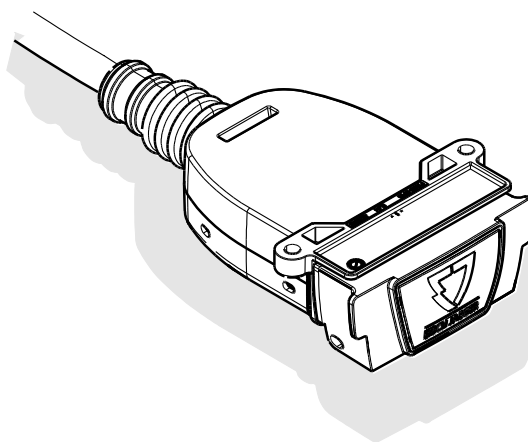

Reference:

The following information must be reviewed before beginning the assembly:

The installation instructions are to be thoroughly read.

The installation should be carried out by qualified personnel with the relevant technical knowledge. The vehicle manufacturers' current technical notices and information on retrofitting must be followed. The removal and replacement instructions found in the current repair manuals must be followed.

It must be ensured that the vehicle is technically suitable for the installation of a trailer hitch.

OVERVIEW

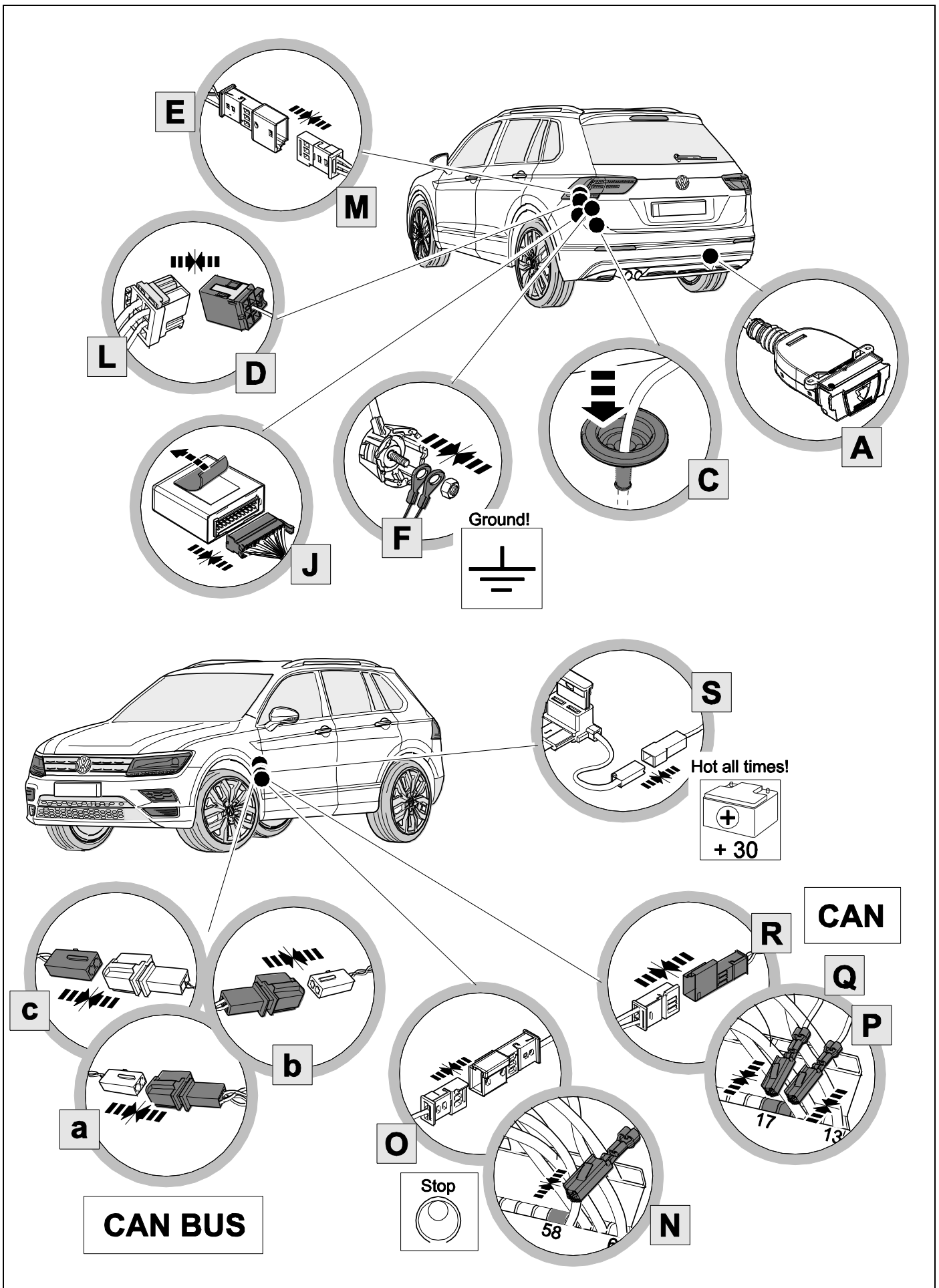

KIT

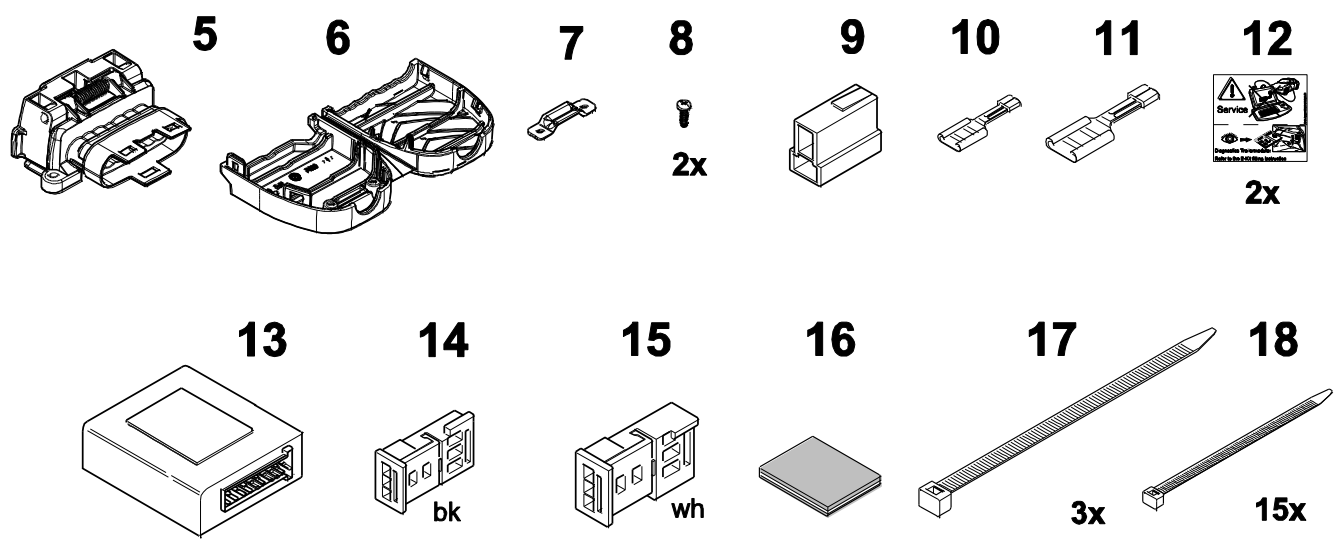
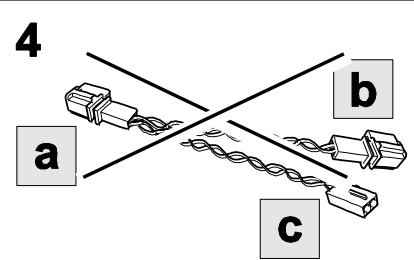
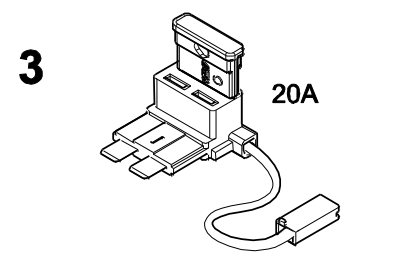
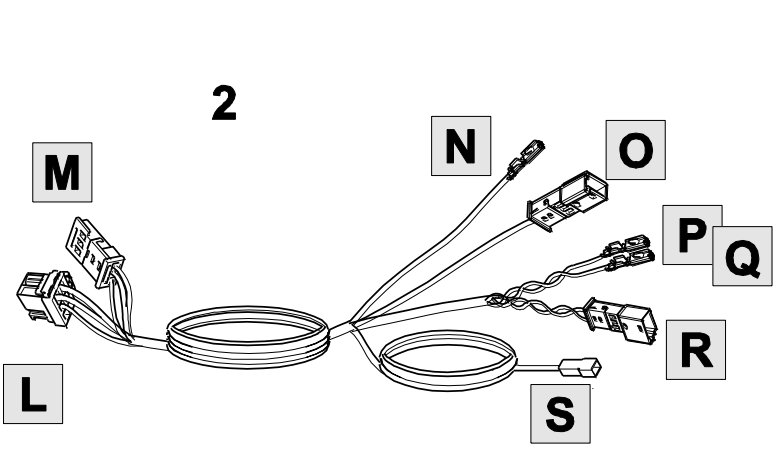
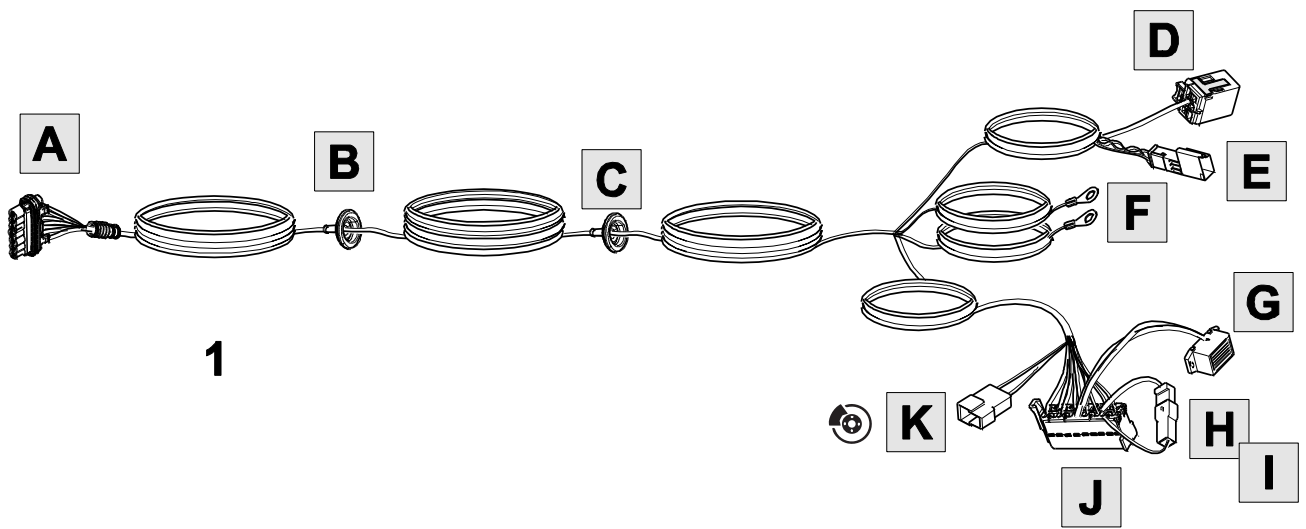

TOOLS

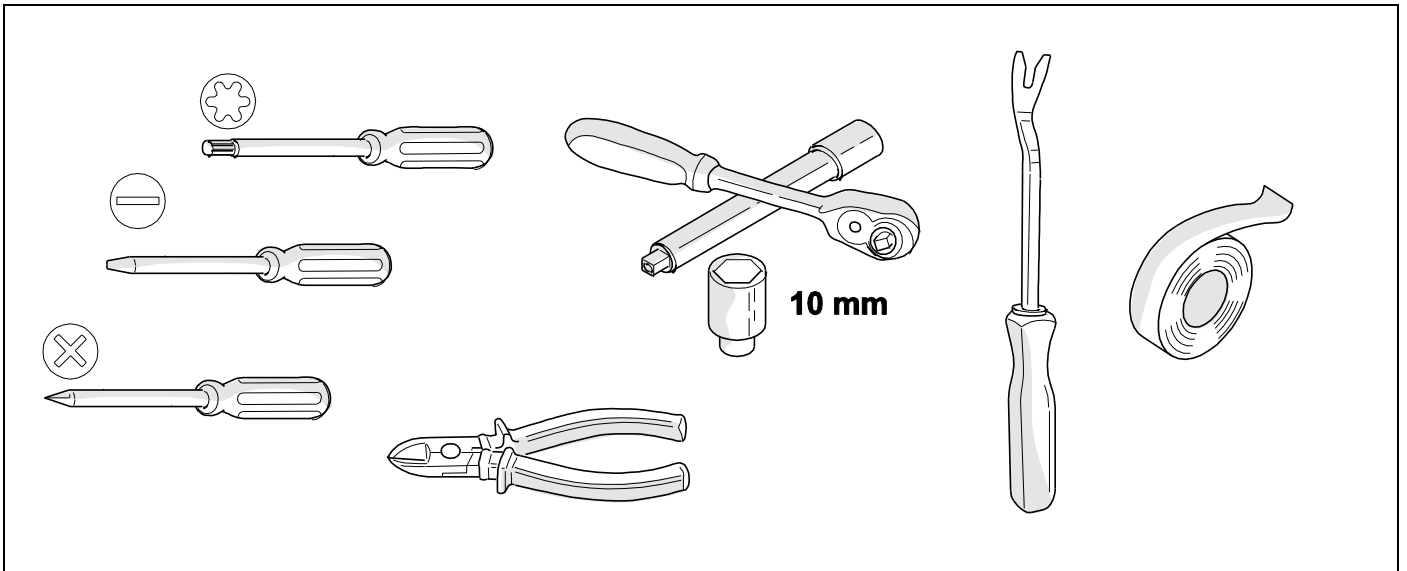

1

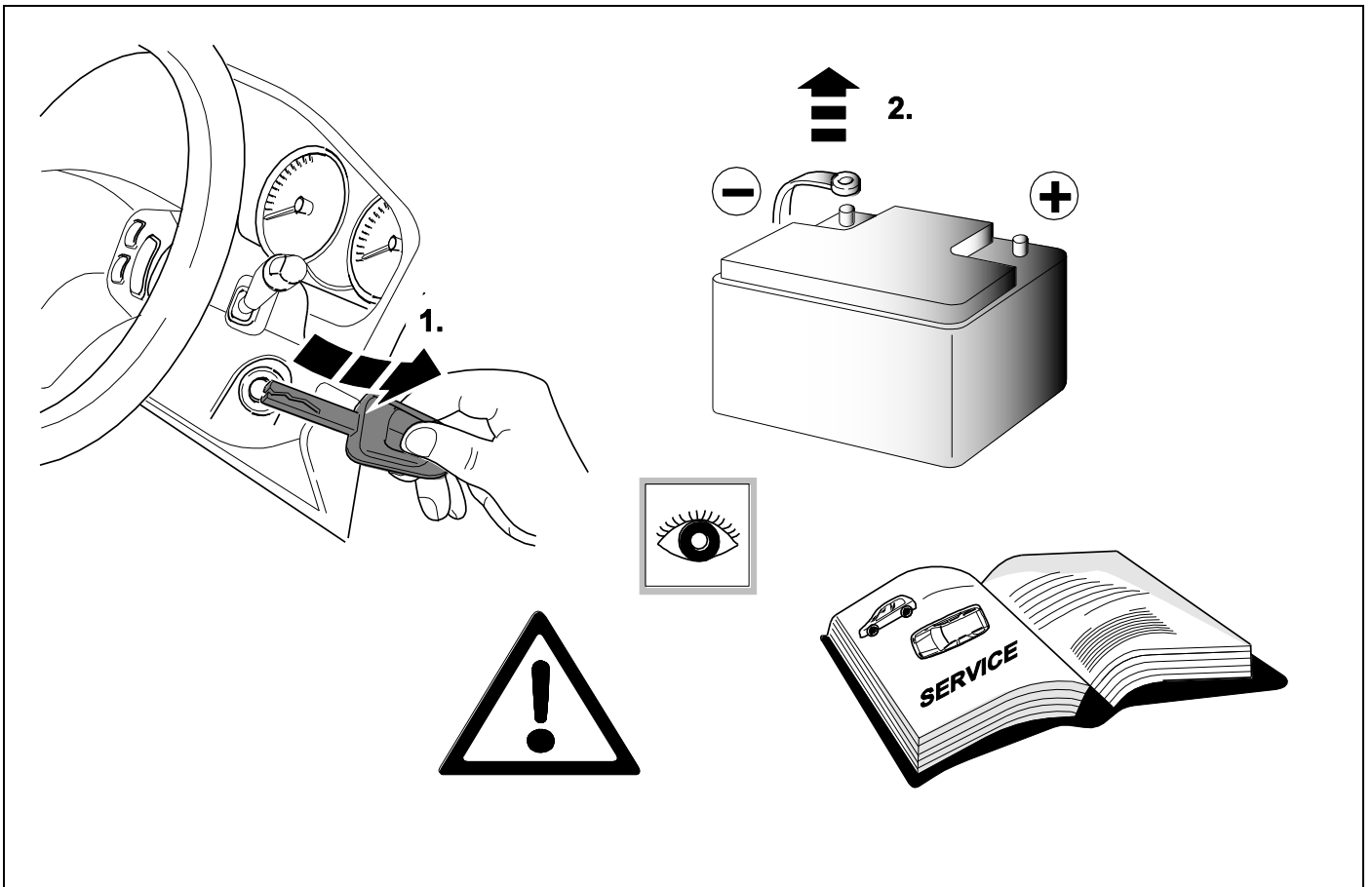

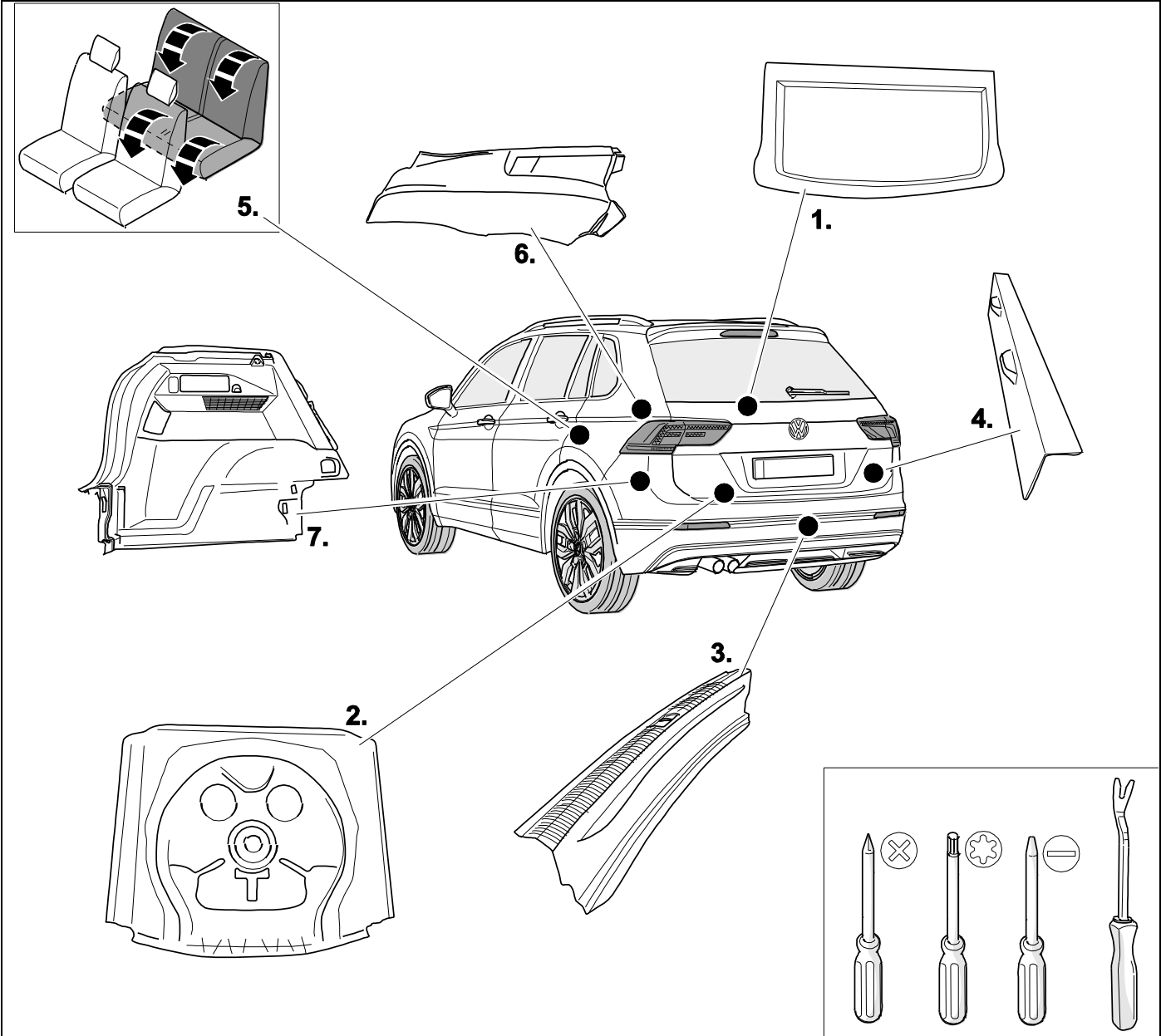

3

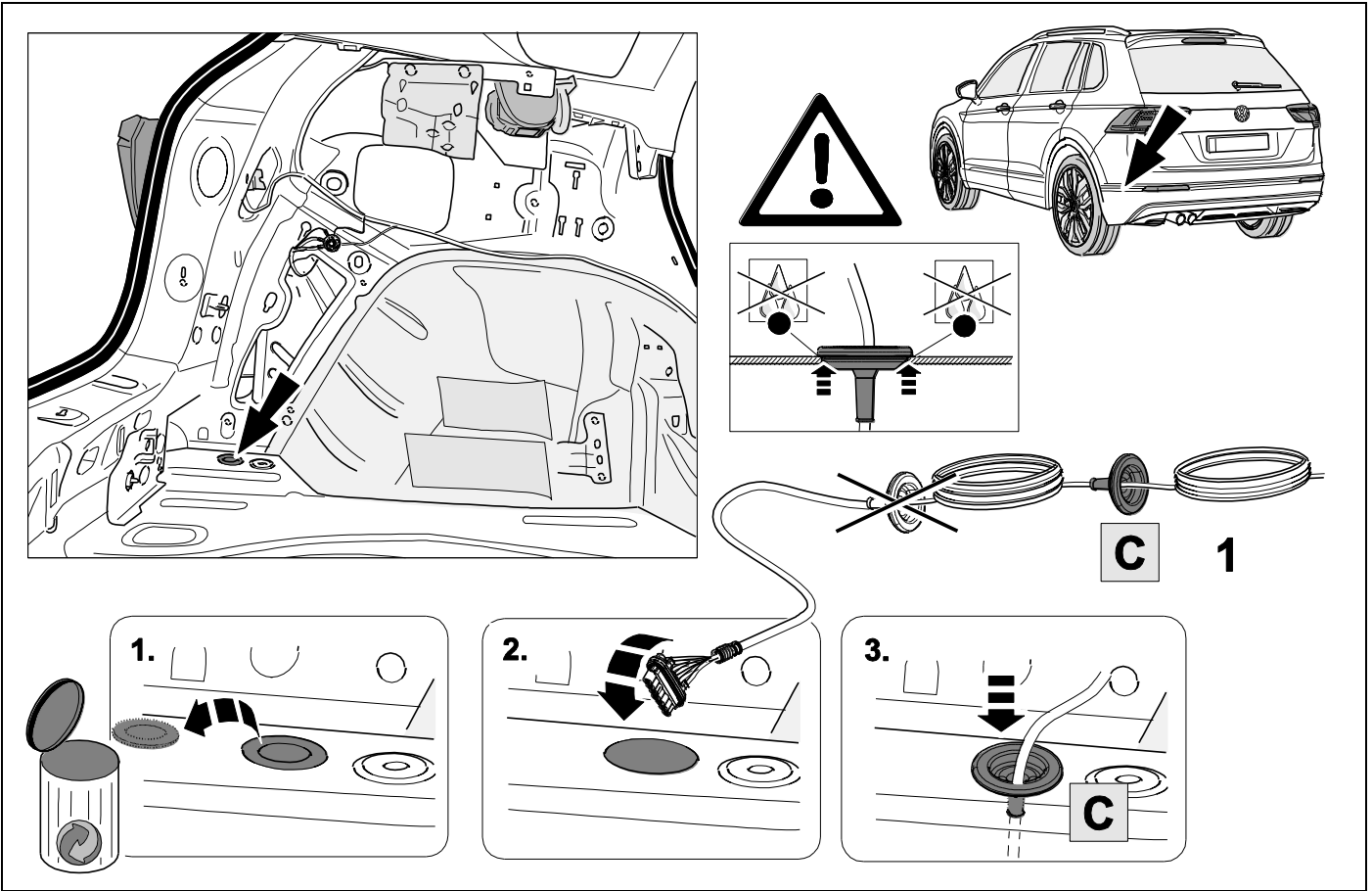

4

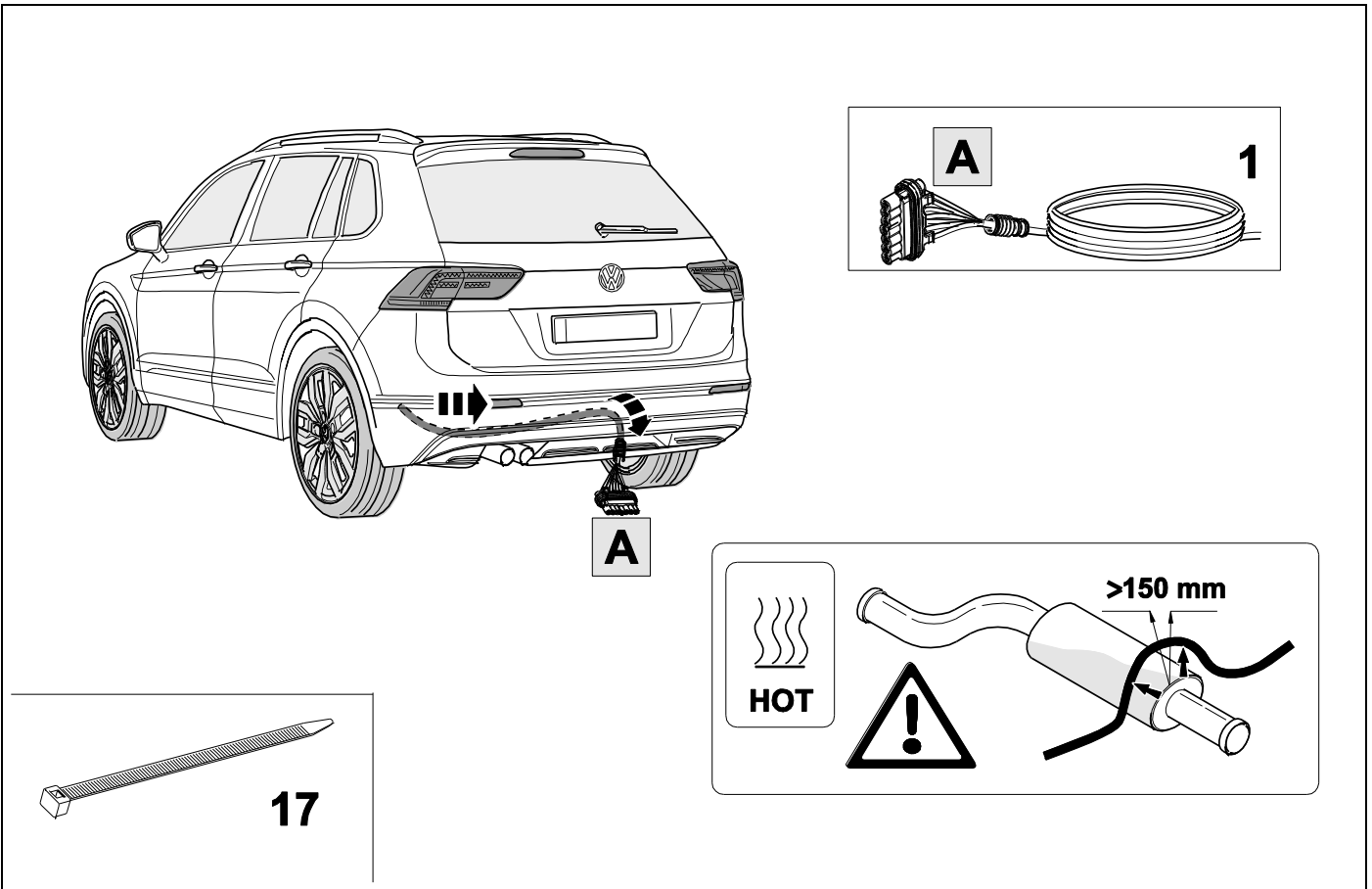

5

8



1. Cable with label **A**

2. Inserting cable into device

3. Circular inset showing internal mechanism with screwdriver

4. Closing the device

5. Final assembly with **CLICK** sound

6. Device housing

7. Screws and screwdriver

8. Internal mechanism

CLICK

CLICK

YouTube
SCAN to WATCH

6

Warning: Exclamation mark in a triangle

Diagram showing the device being mounted to a wall bracket using screws.

7⇒ **8**

1	ye	
2	bk	
3	wh	
4	gn	
5	bu	
6	rd	
7	bn	

8	bk	wh	gy	gn	rd	bu	ye	bn	pu	or	no
----------	-----------	-----------	-----------	-----------	-----------	-----------	-----------	-----------	-----------	-----------	-----------

	black	white	grey	green	red	blue	yellow	brown	purple	orange	not occupied
---	-------	-------	------	-------	-----	------	--------	-------	--------	--------	--------------

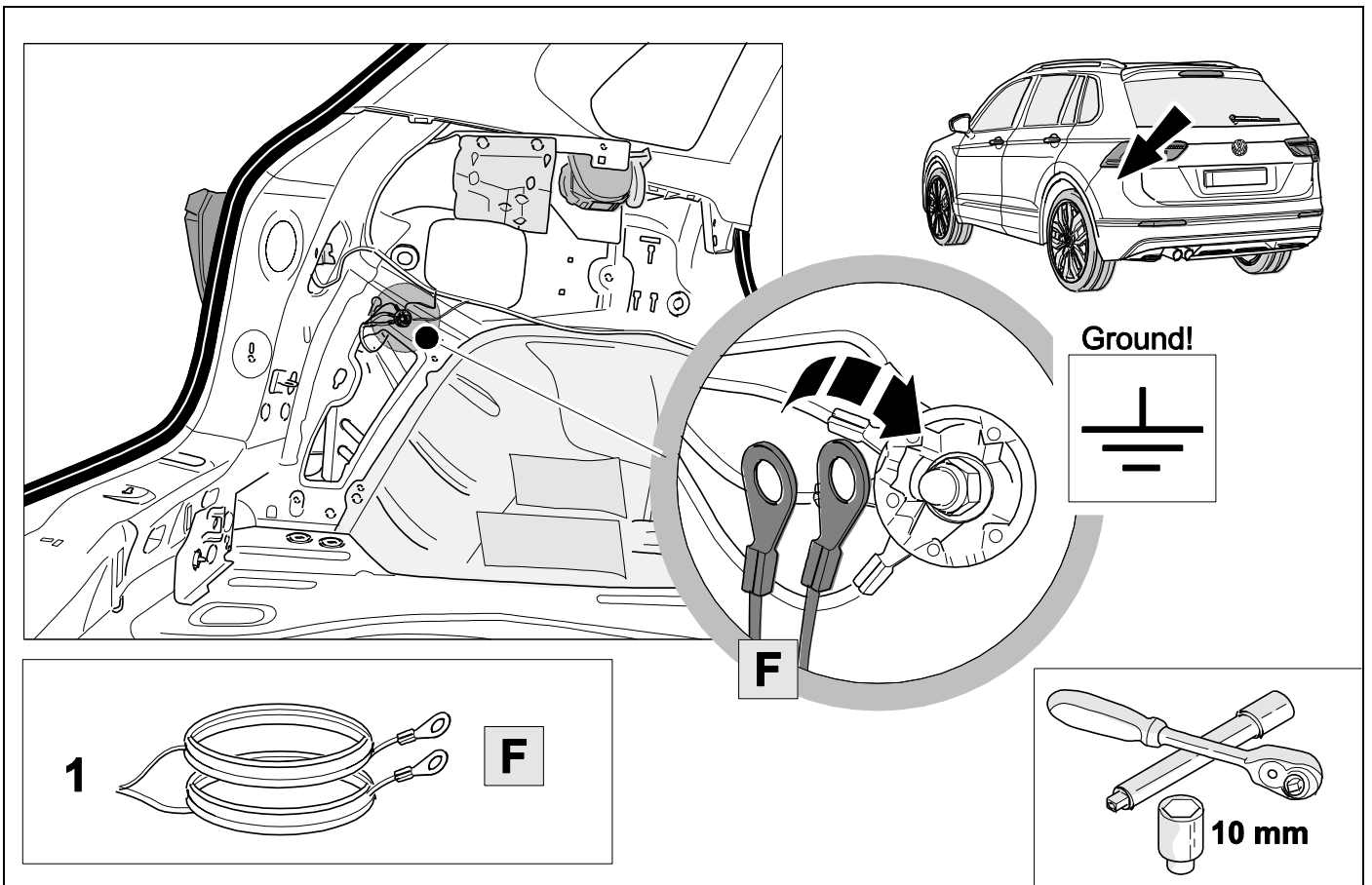
9

10

⇒ 8

Vehicles with trailer preparation

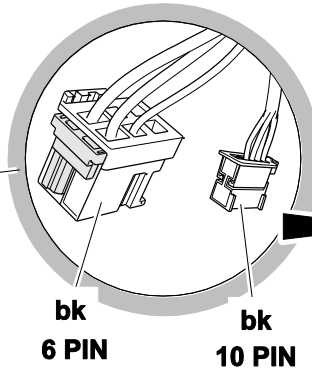
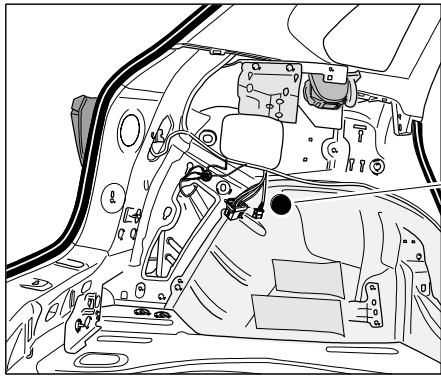

OPTION 1

11 ⇒ 17

32 ⇒ 43

Vehicles without trailer preparation

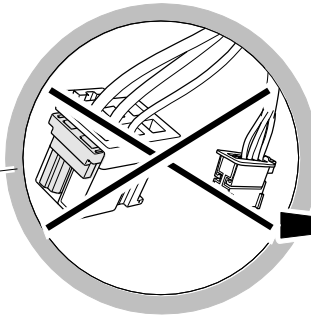
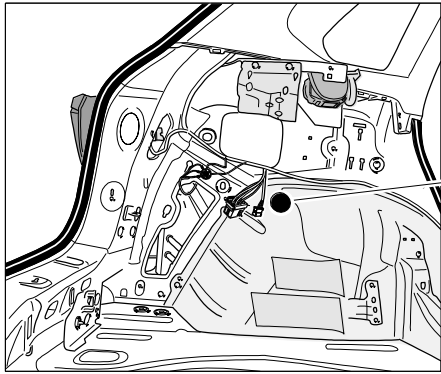

OPTION 2

18 ⇒ 43

11

⇒ 8

OPTION 1

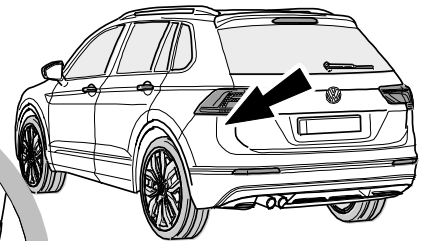
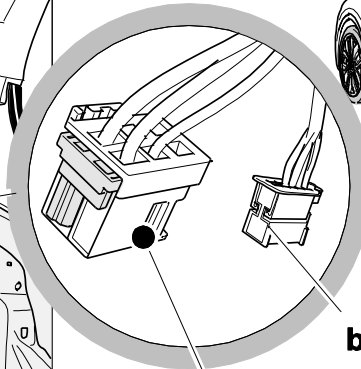
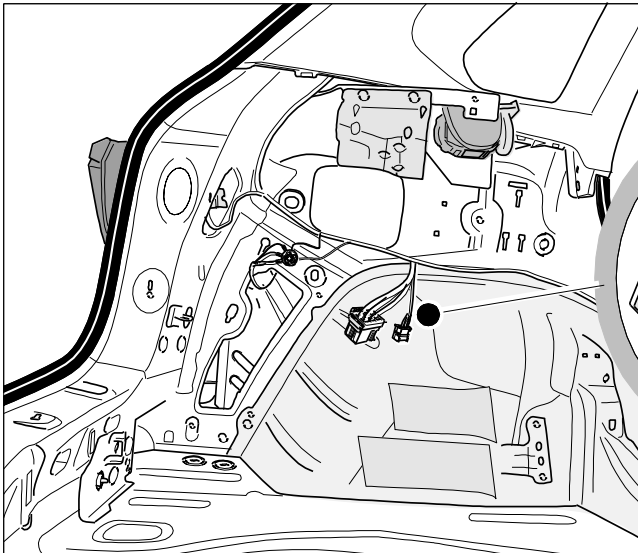

bk
6 PIN

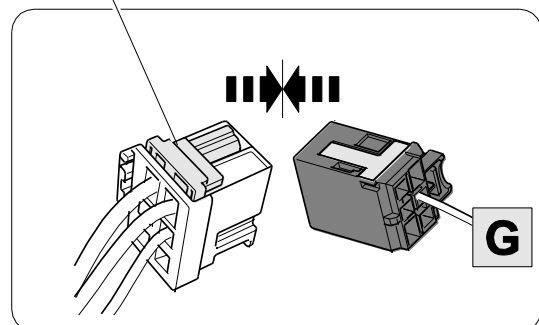
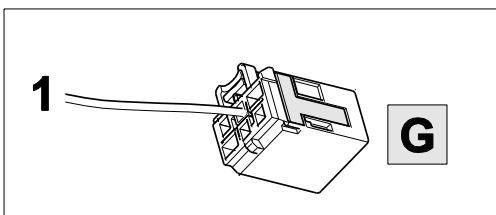

12

⇒ 8

OPTION 1

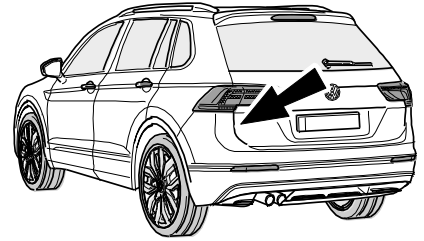
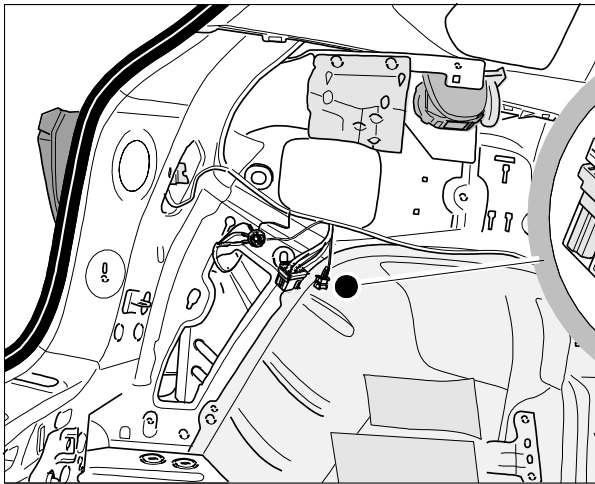

bk
10 PIN

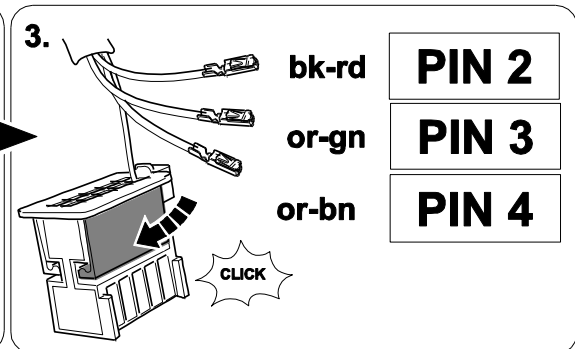
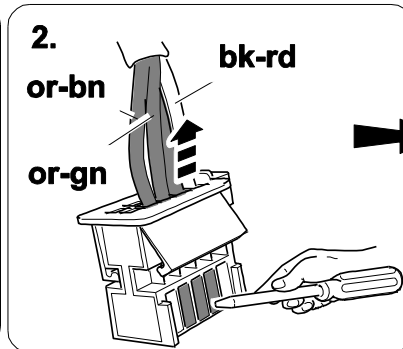
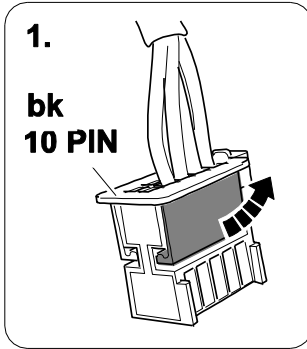

13

⇒ 8

OPTION 1

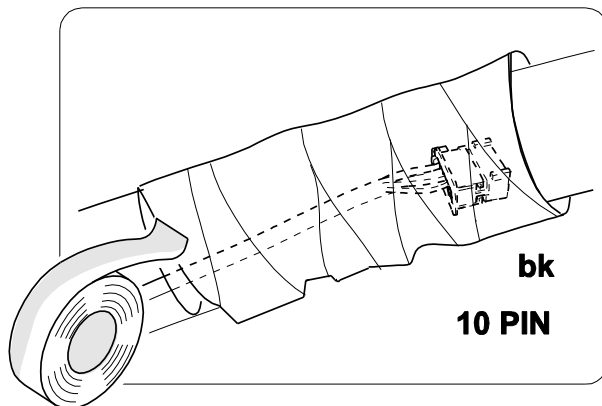
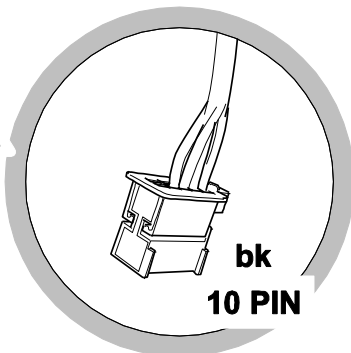
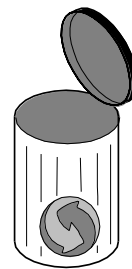
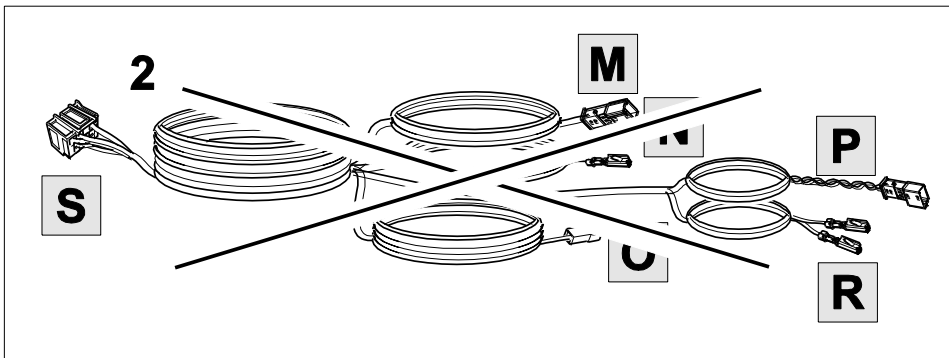

14

⇒ 8

OPTION 1

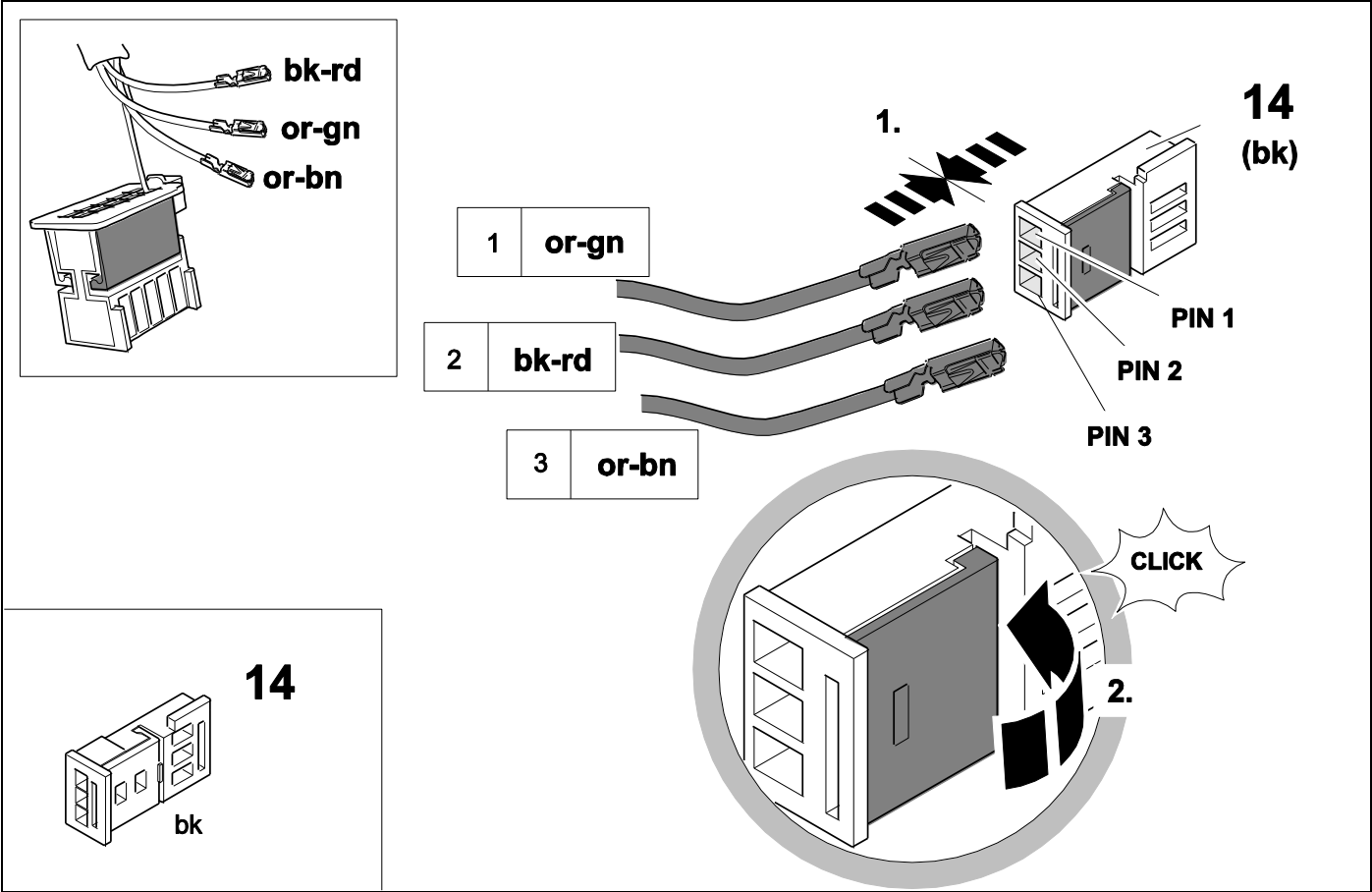

15

OPTION 1

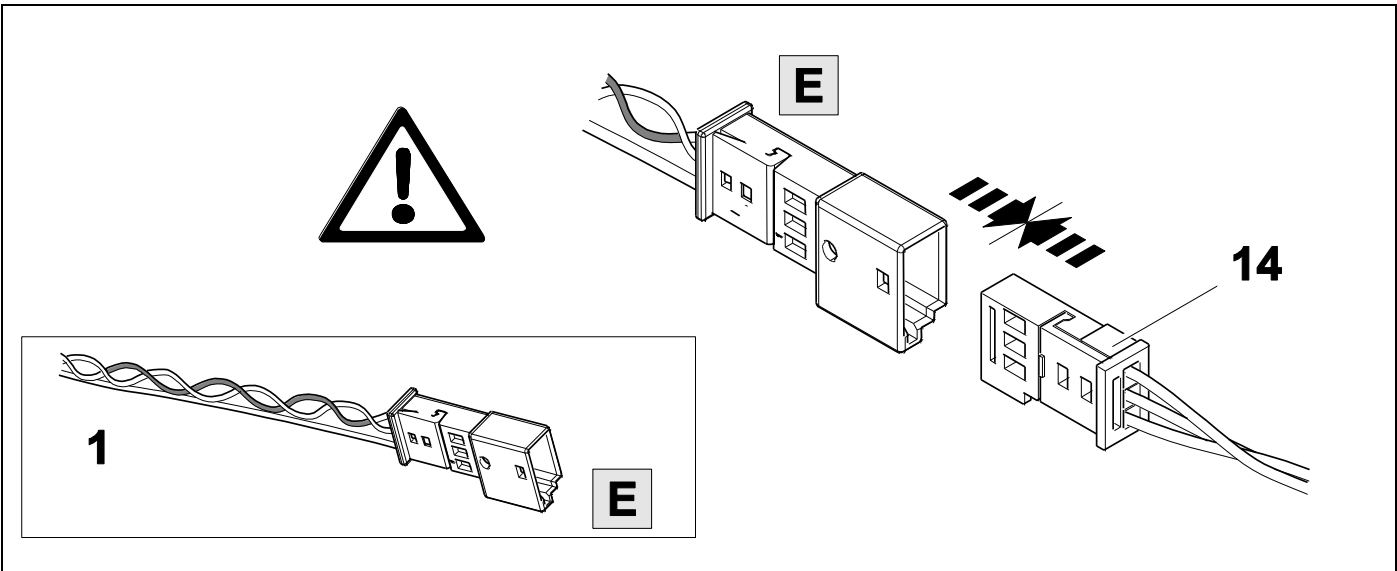

16



8

OPTION 1

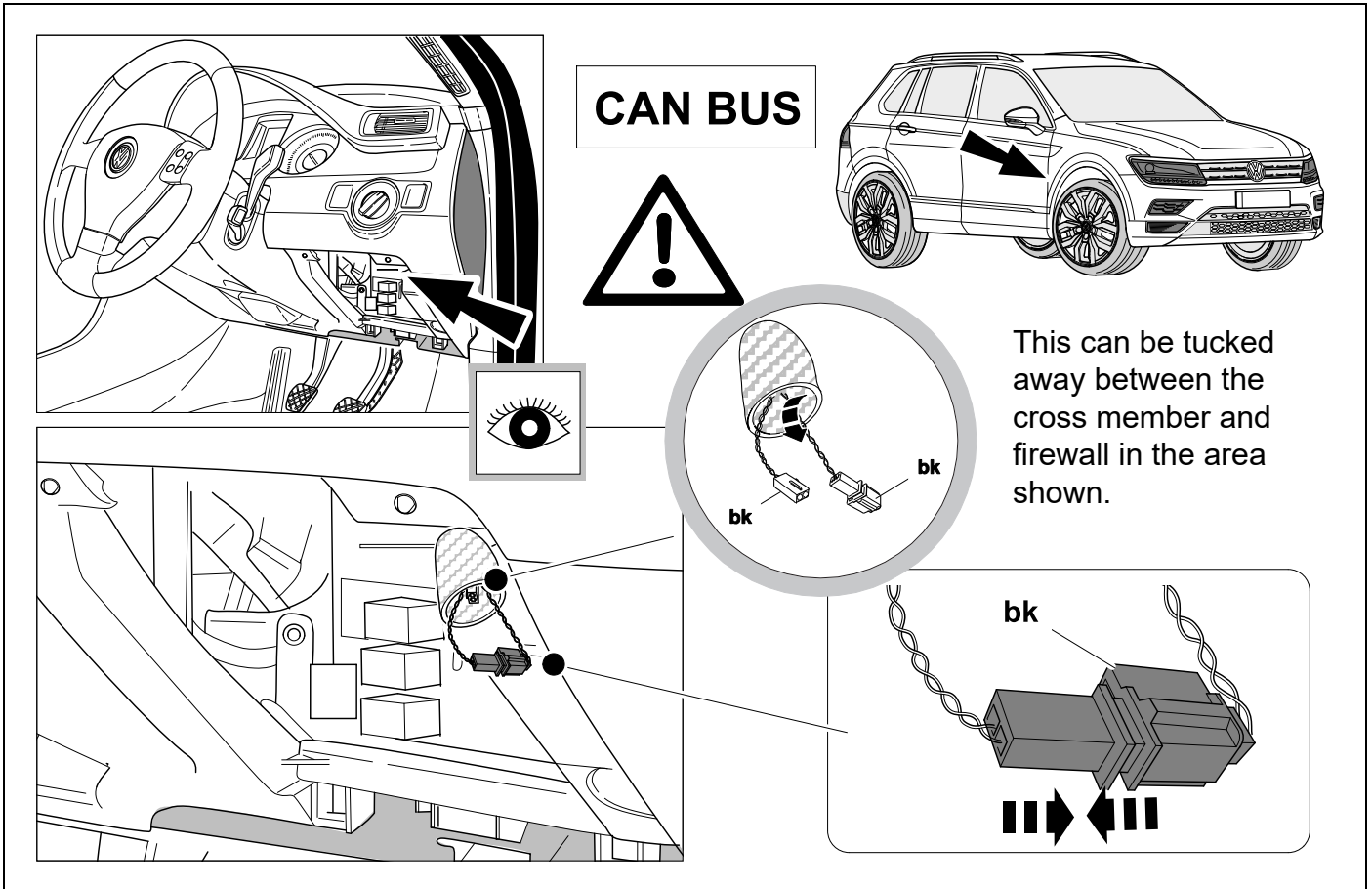

17

OPTION 1

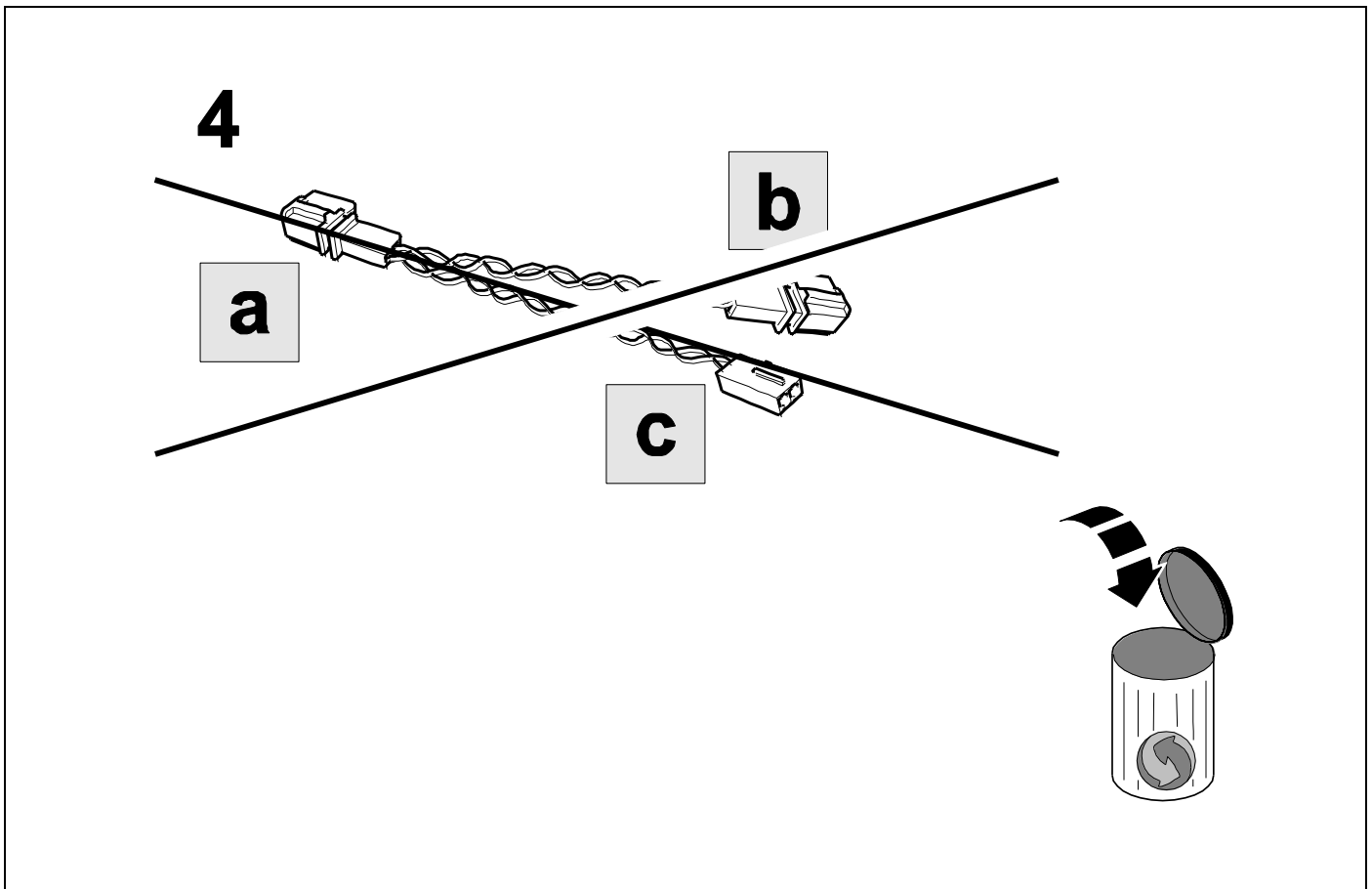

18

OPTION 2

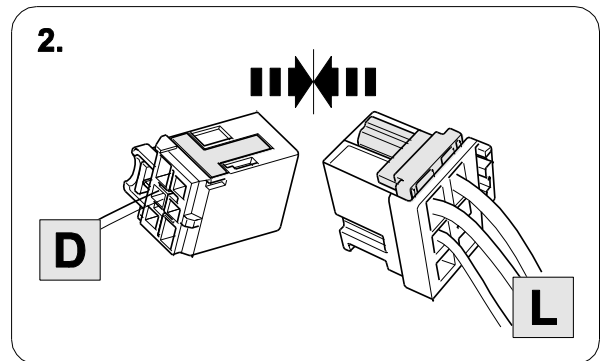
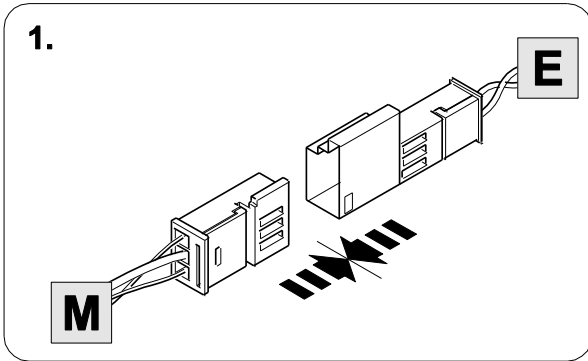
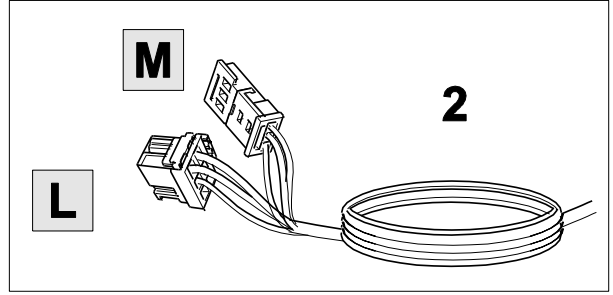
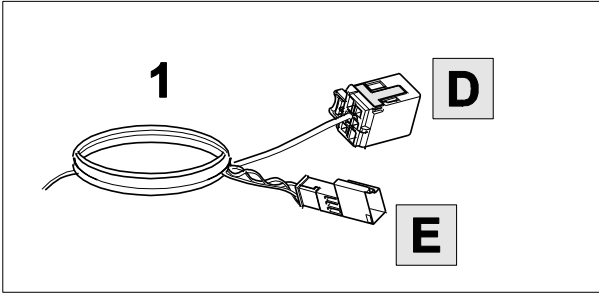

19

OPTION 2

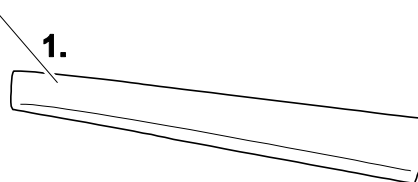
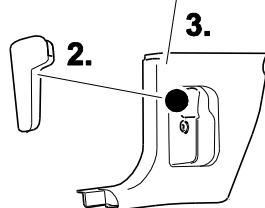
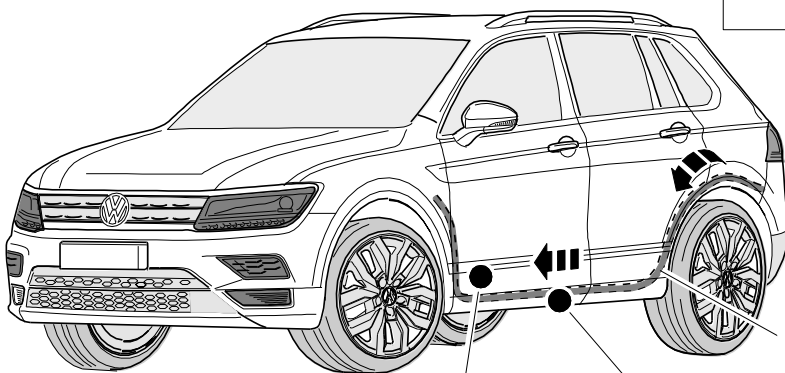
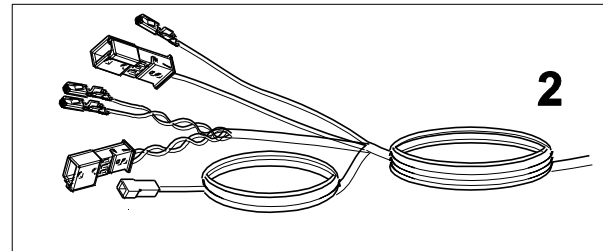

20

OPTION 2

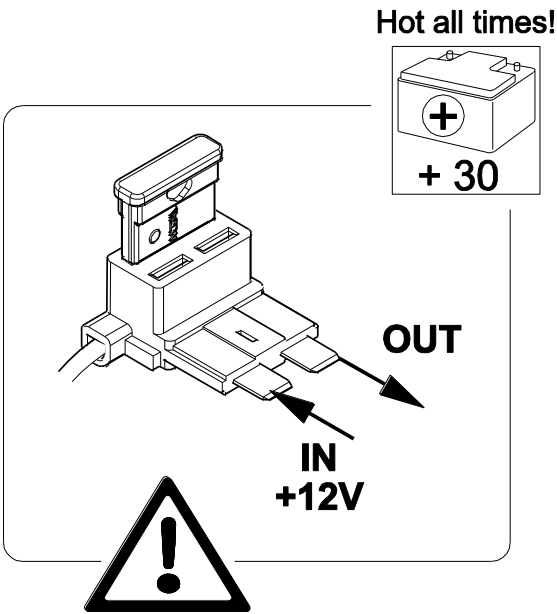
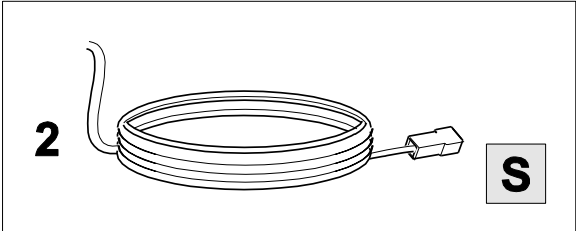
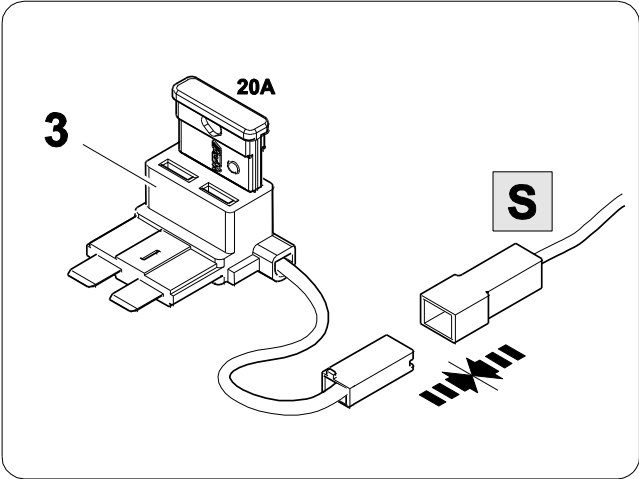

21

⇒ 39

OPTION 2

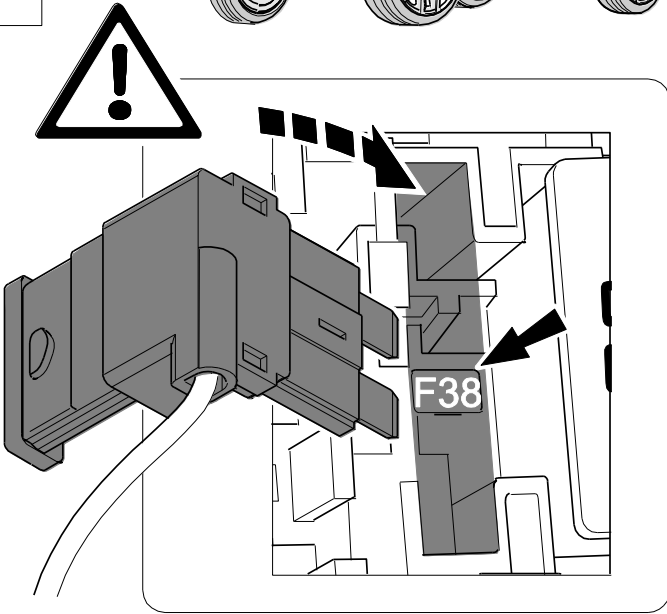
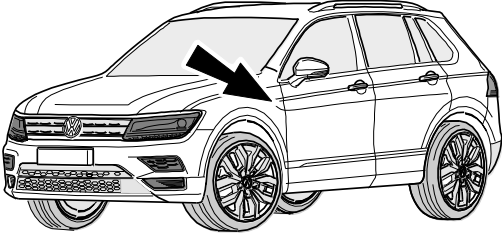
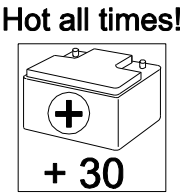
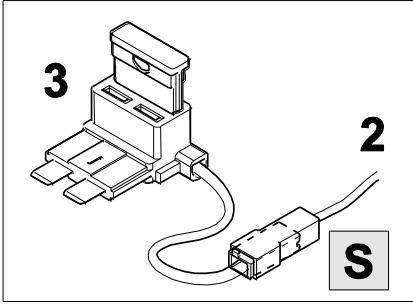

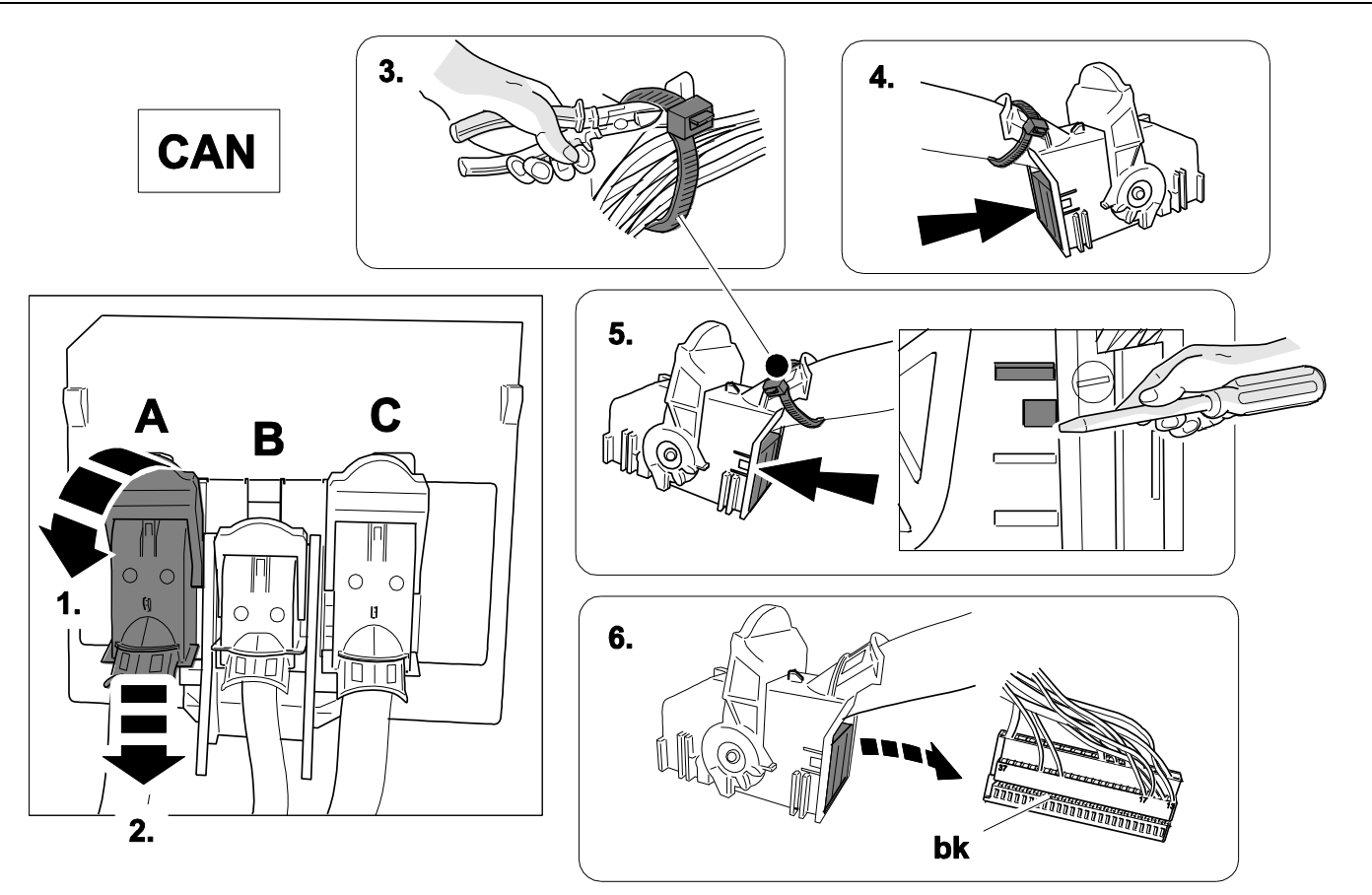
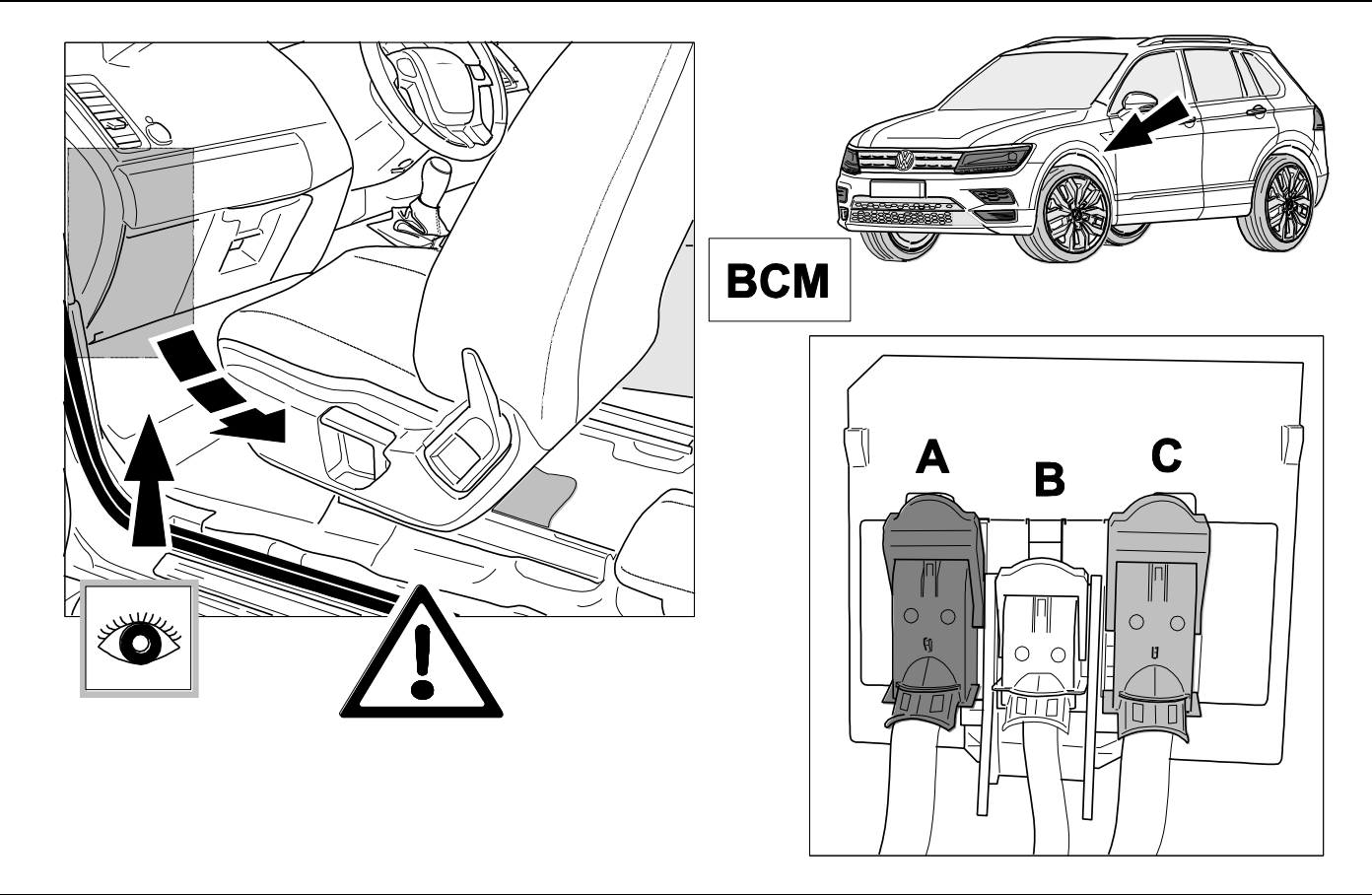

24

⇒ 8

OPTION 2

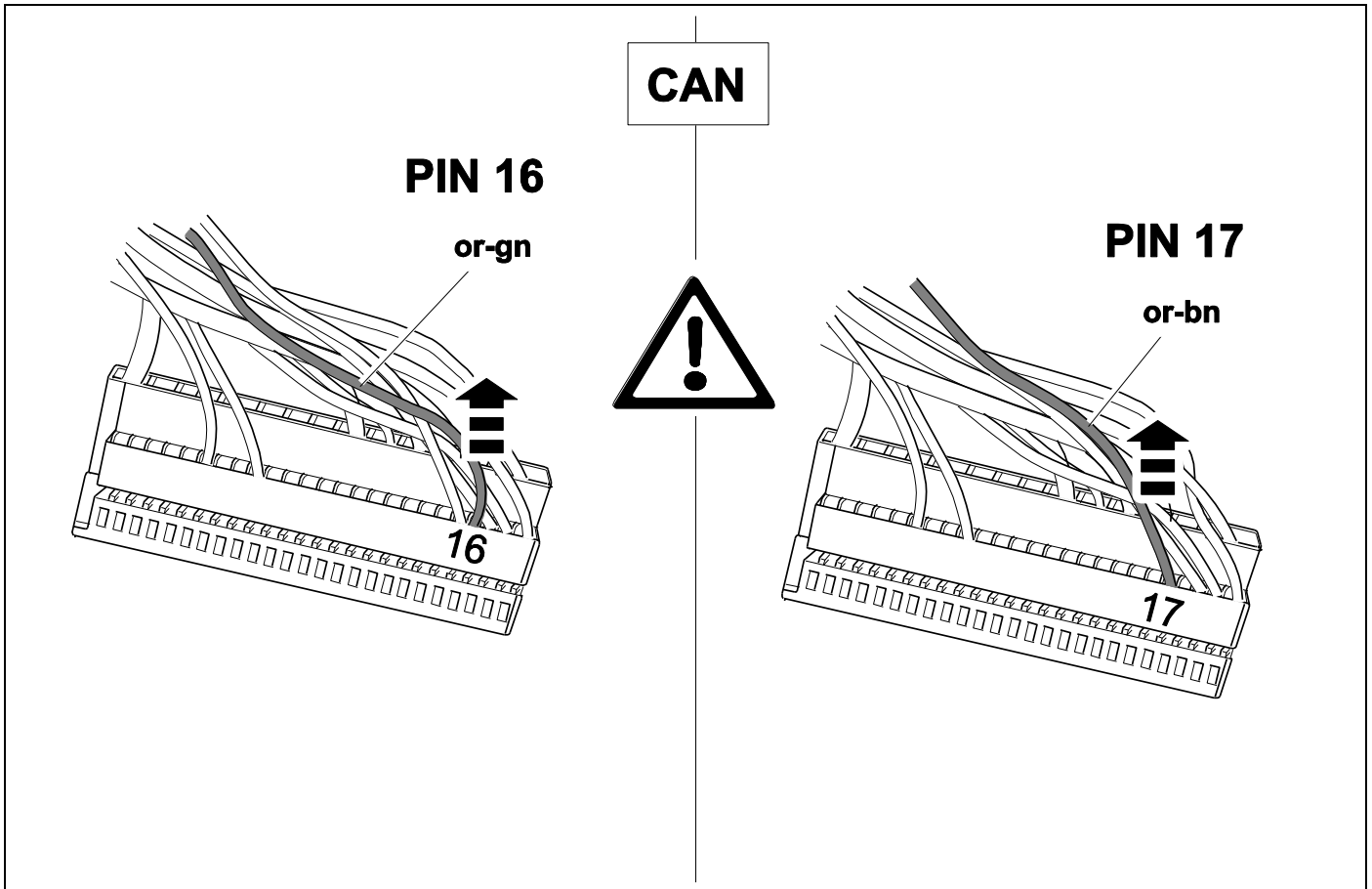

25

⇒ 8

OPTION 2

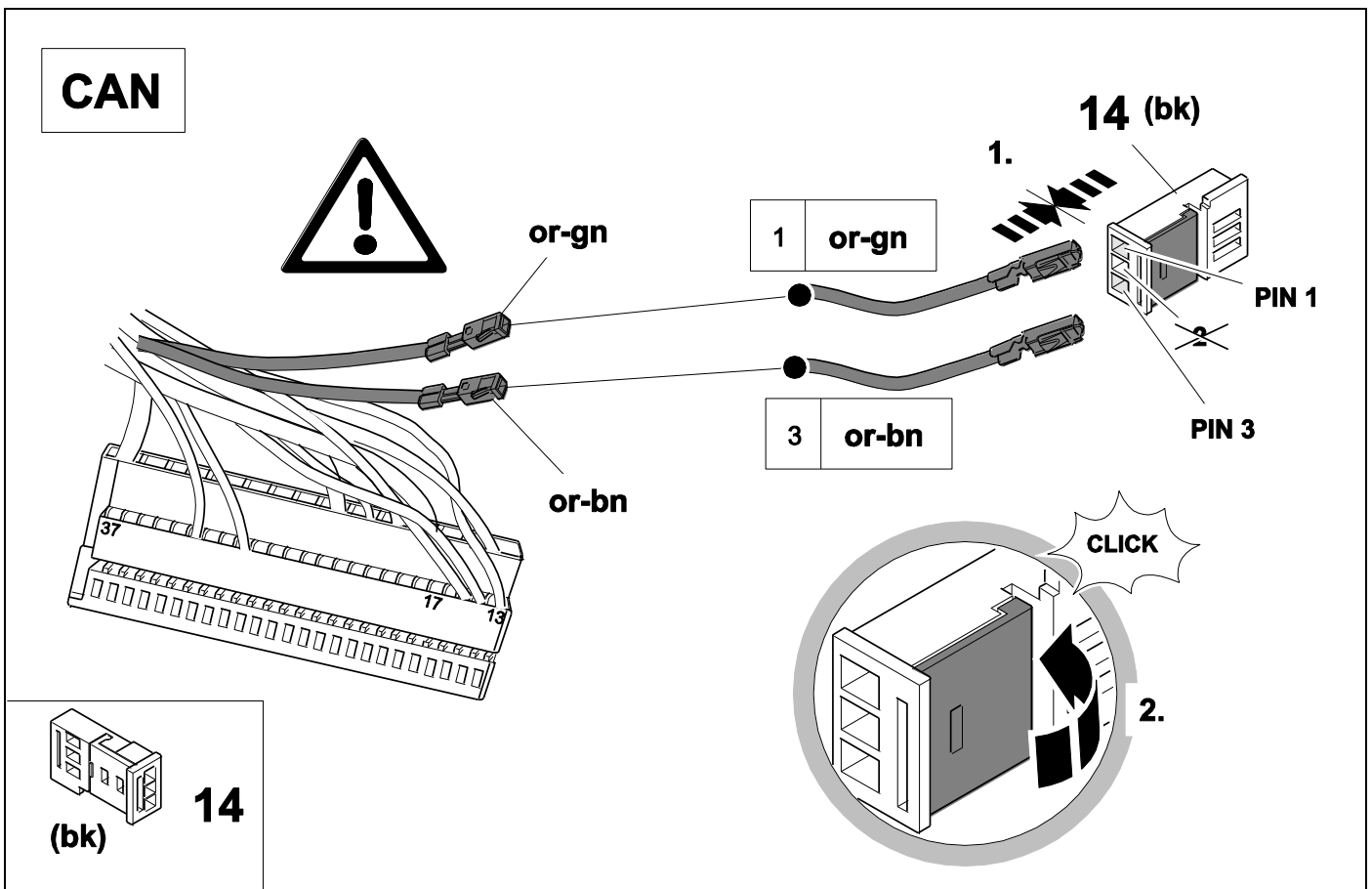

CAN

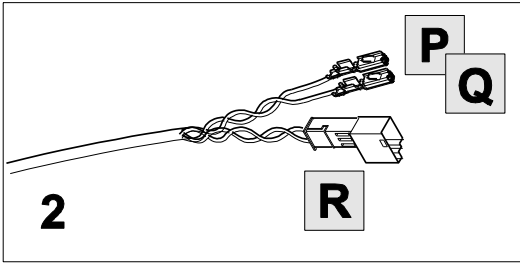
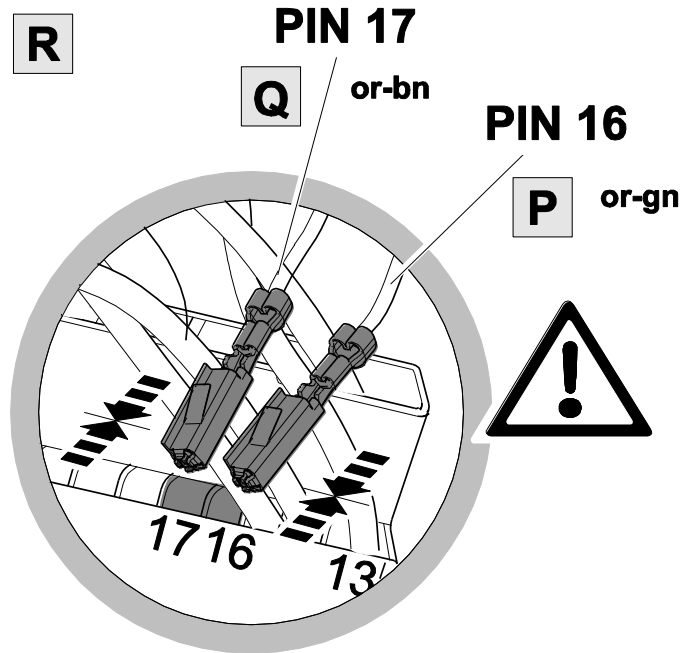
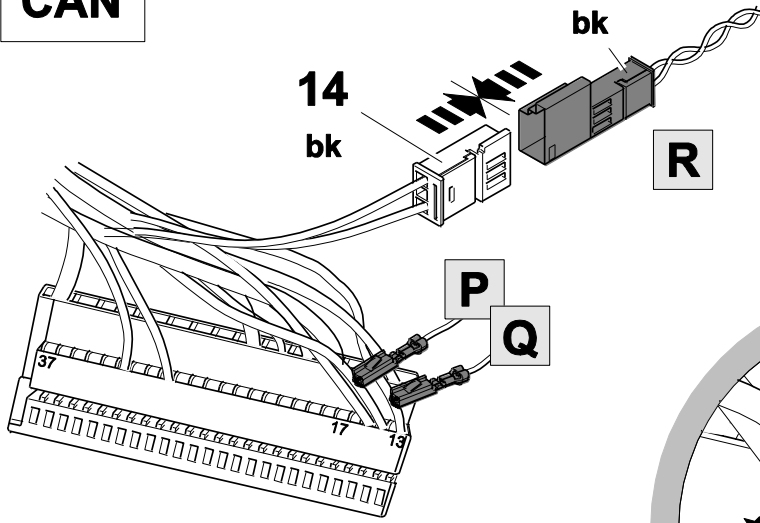

CAN

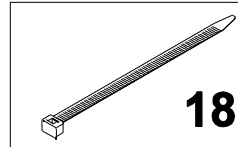
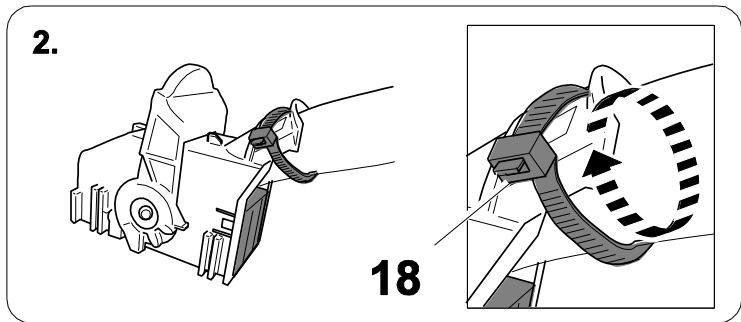
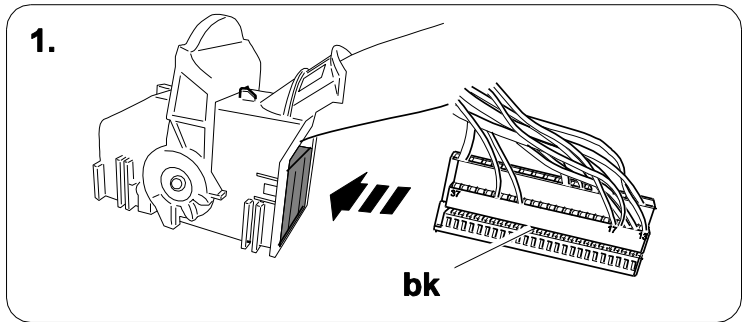
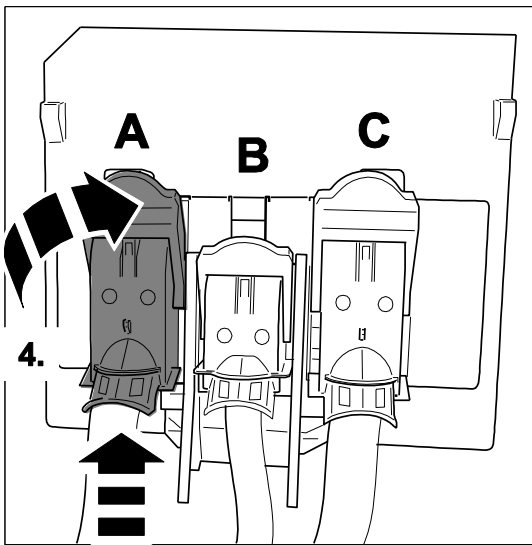

CAN

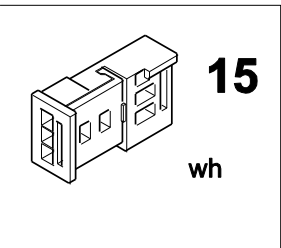
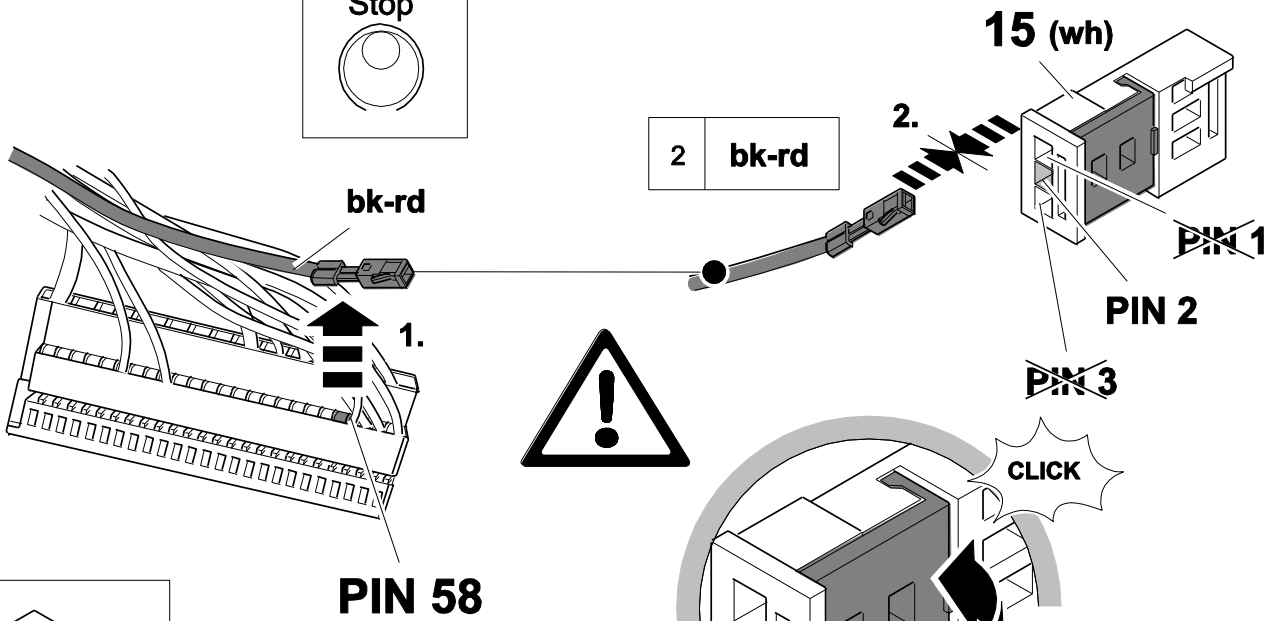
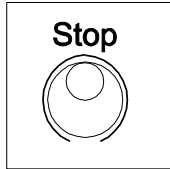
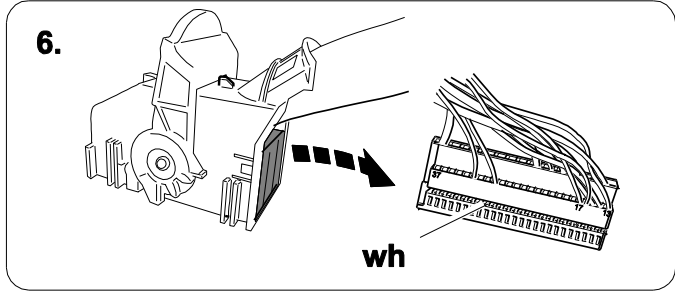
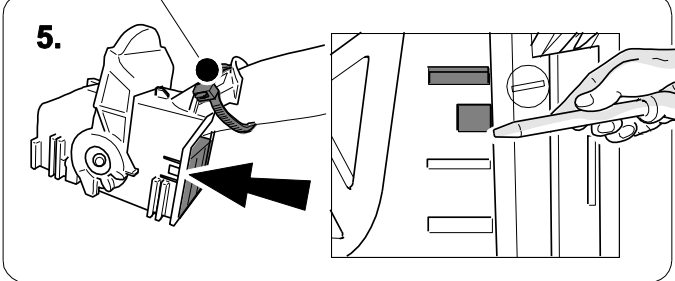
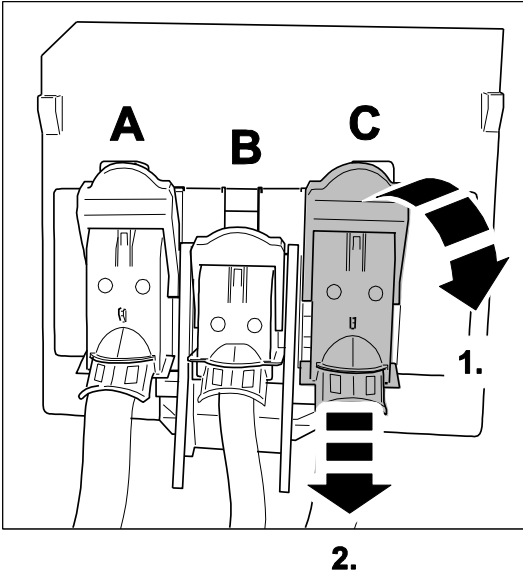
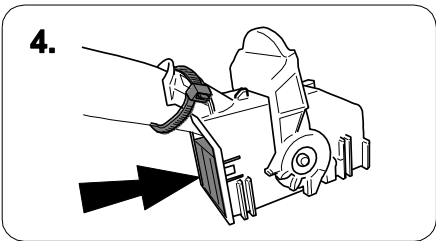
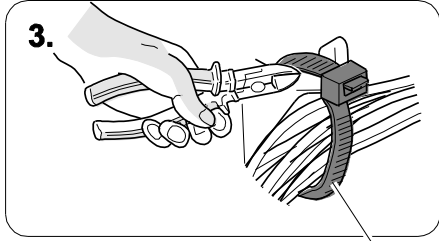

30

⇒ 8

OPTION 2

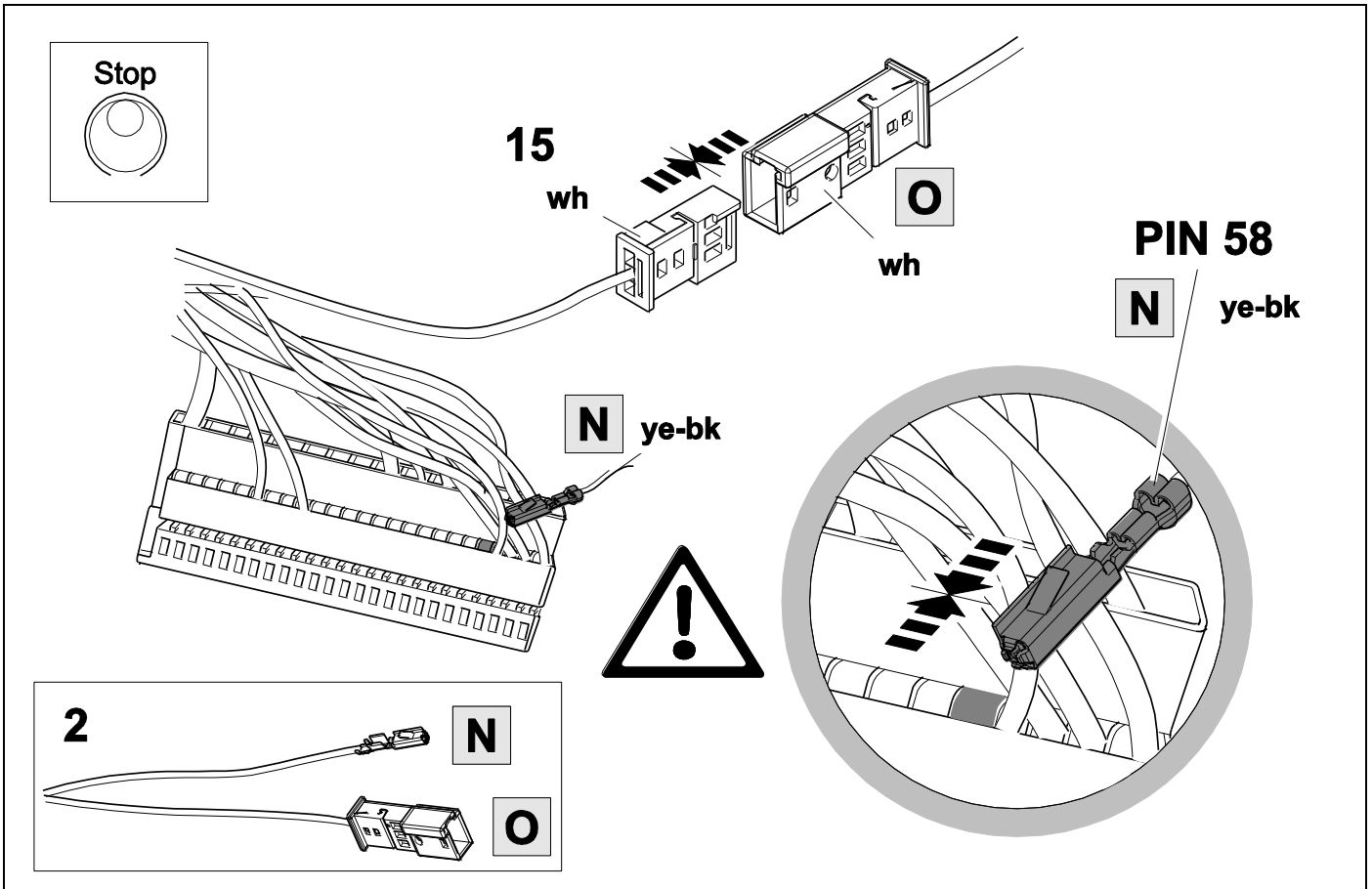

31

⇒ 8

OPTION 2

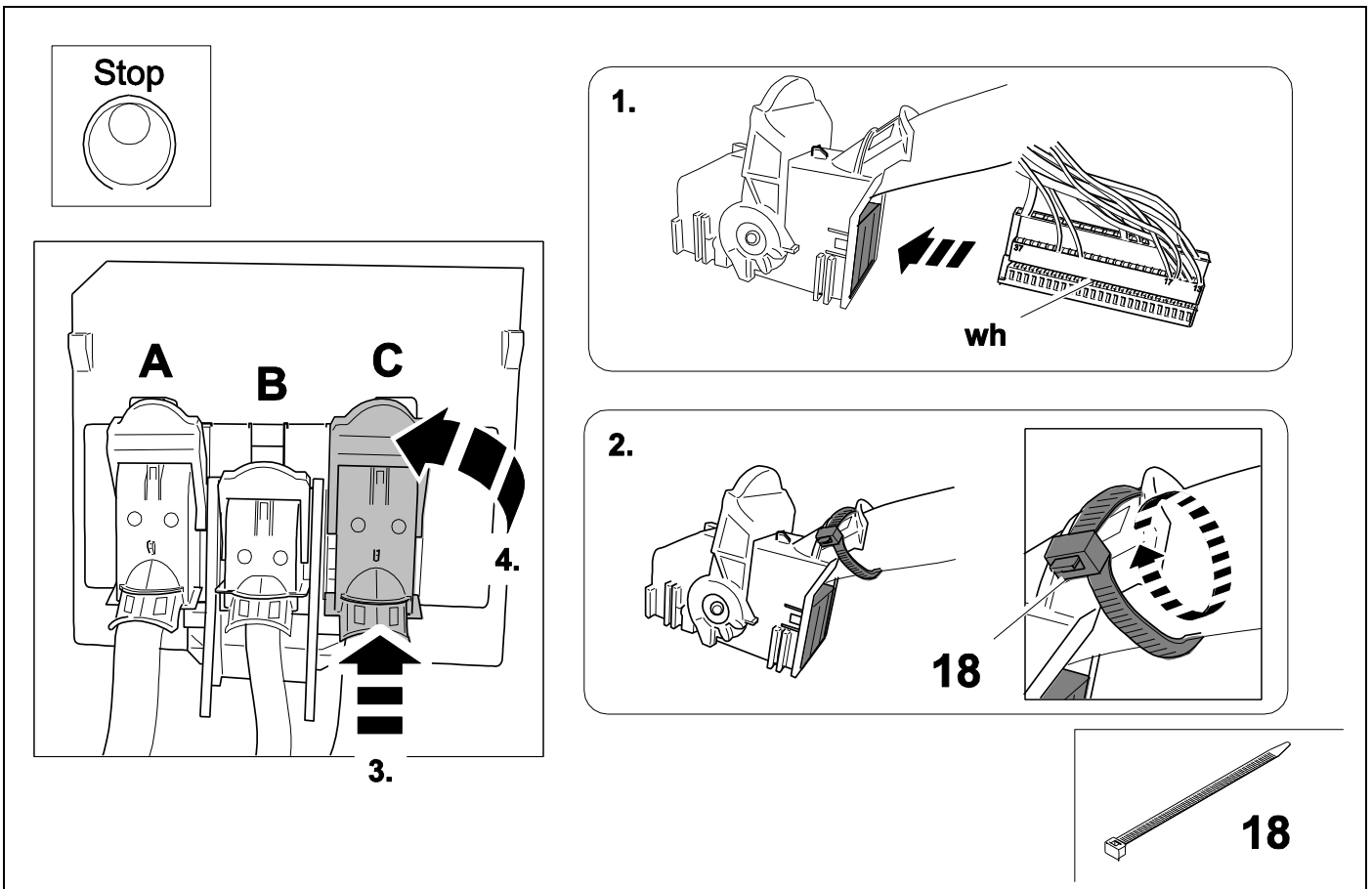

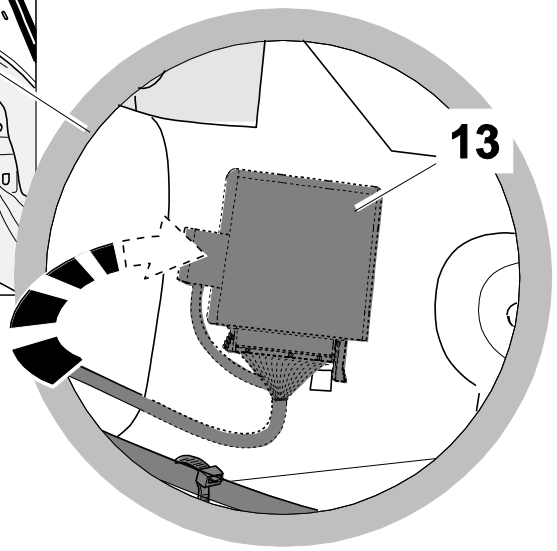
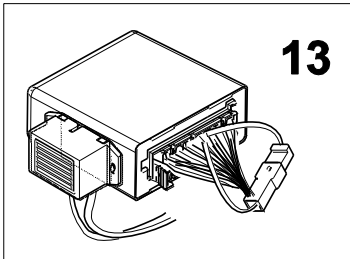
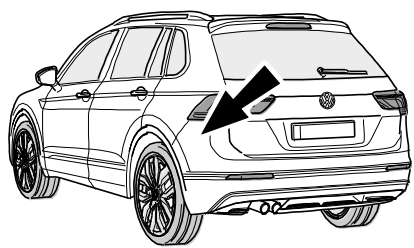
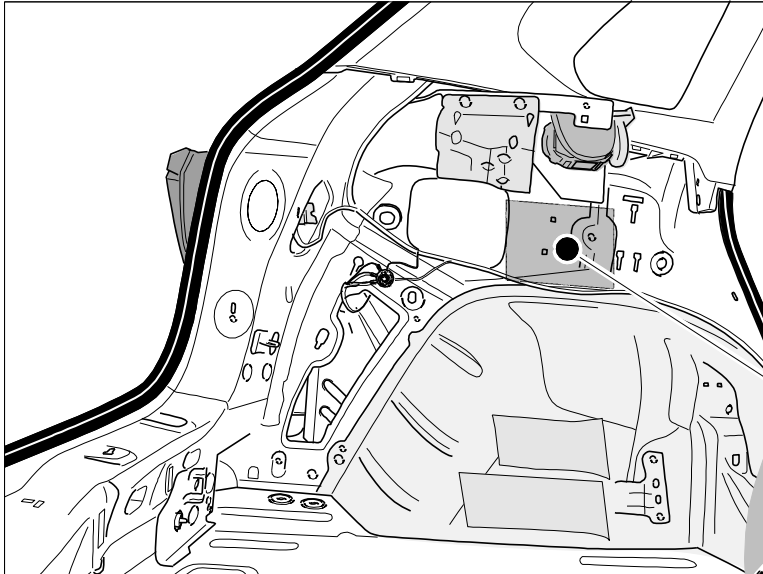
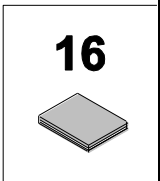
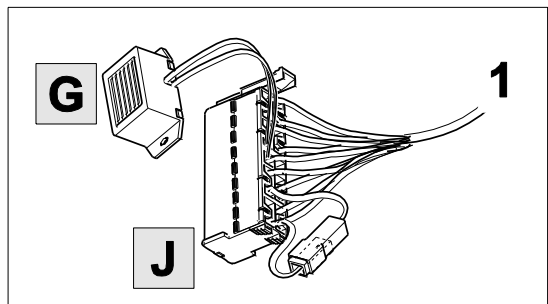
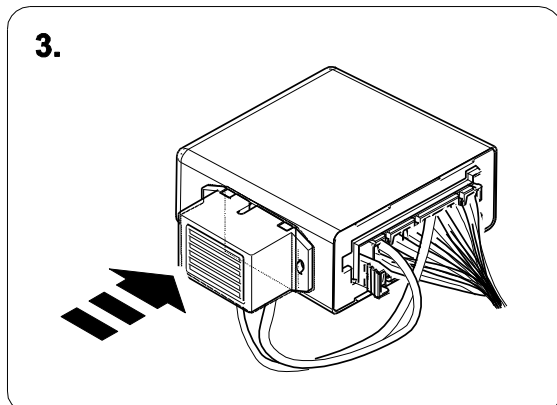
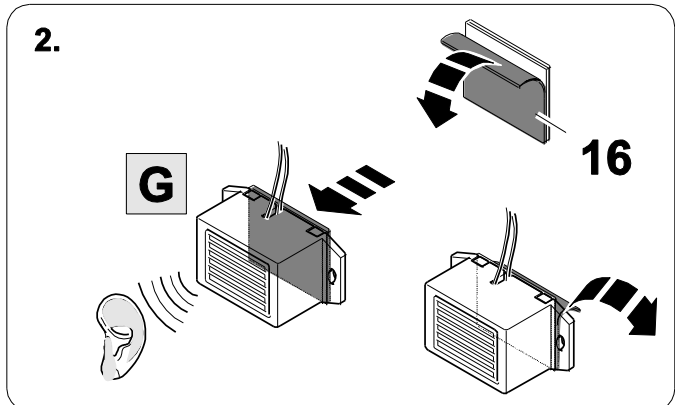
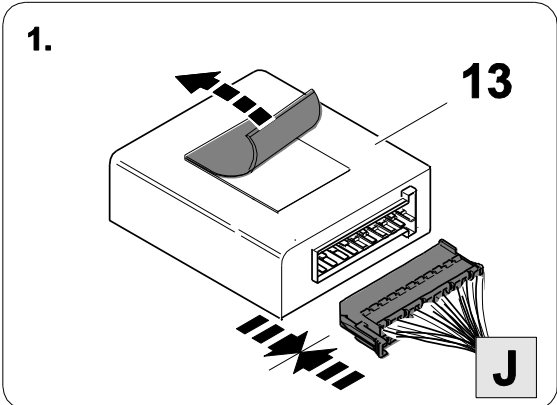

Trailer Brake Preparation

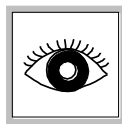
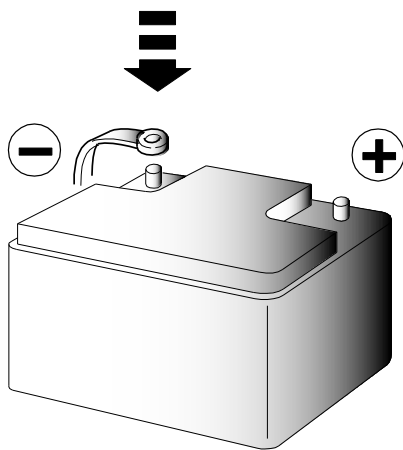
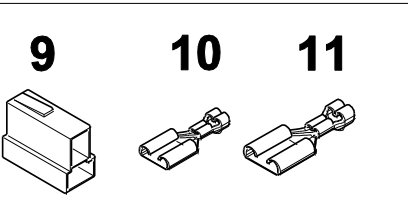
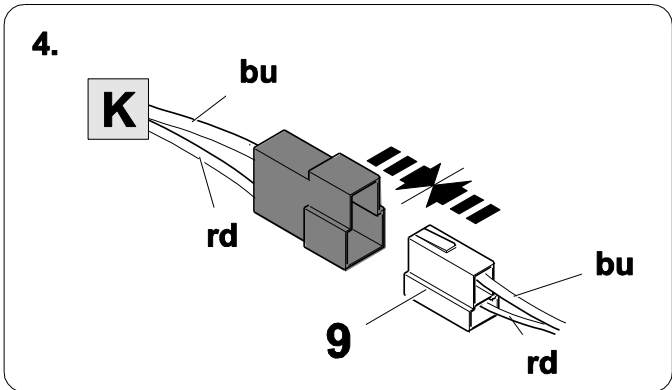
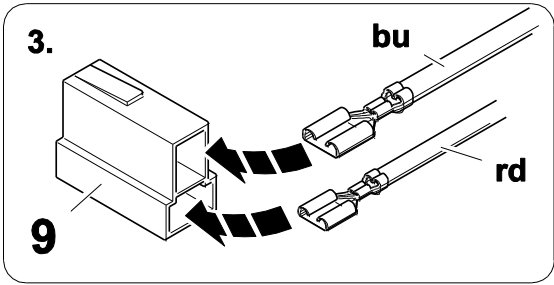
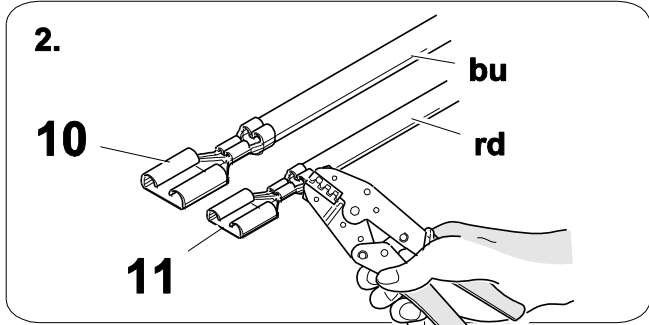
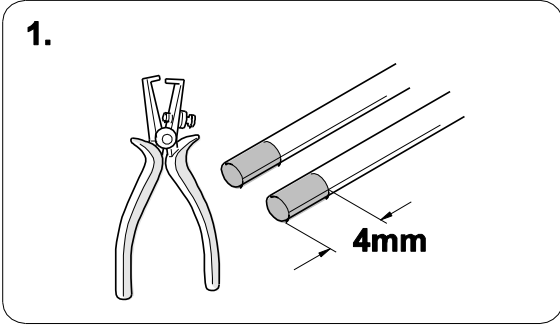
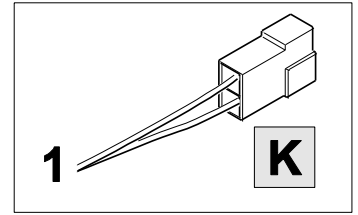

36

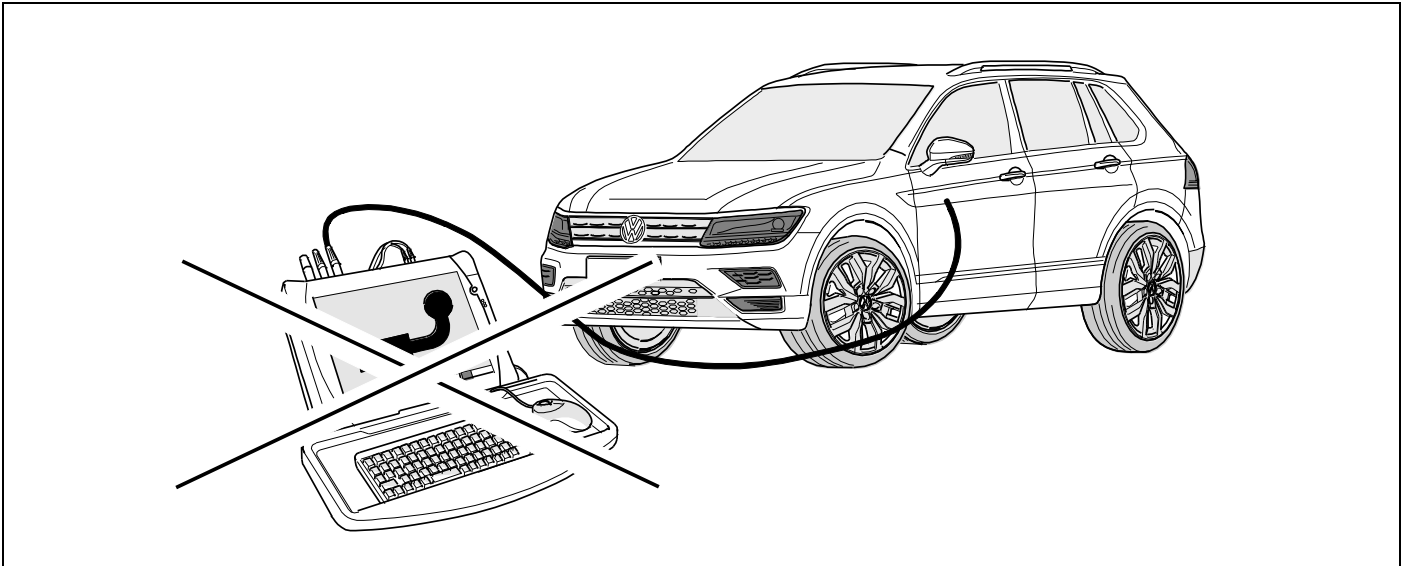

37

CHECK ALL LIGHTING FUNCTIONS

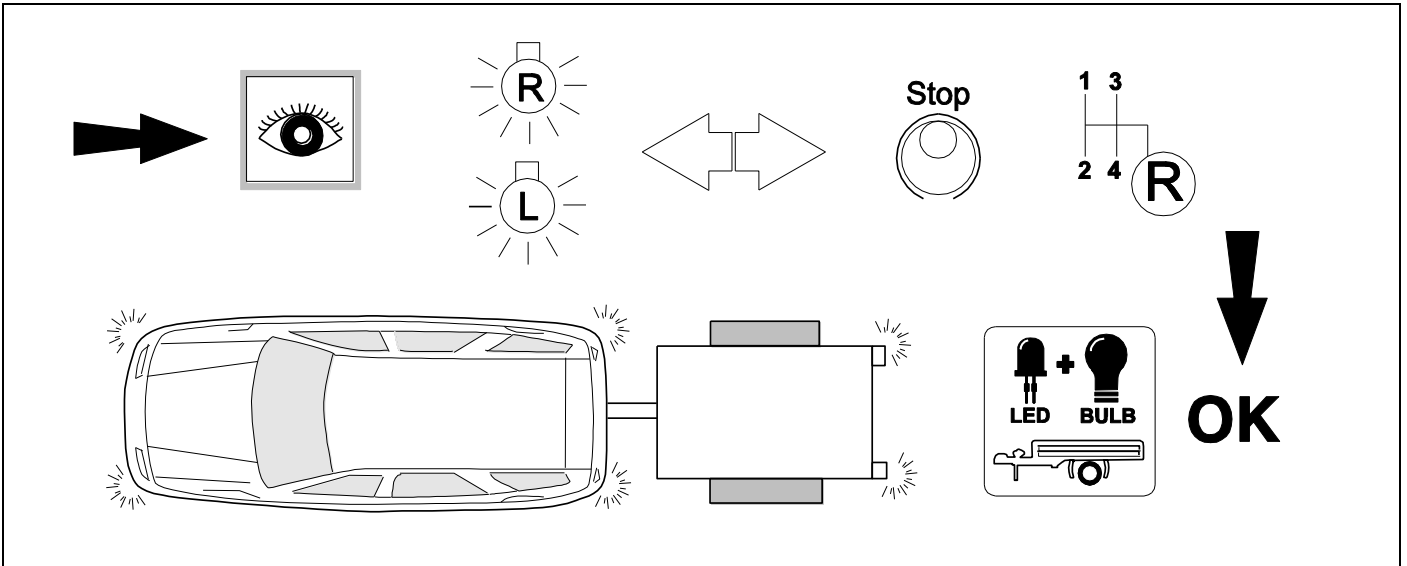

38

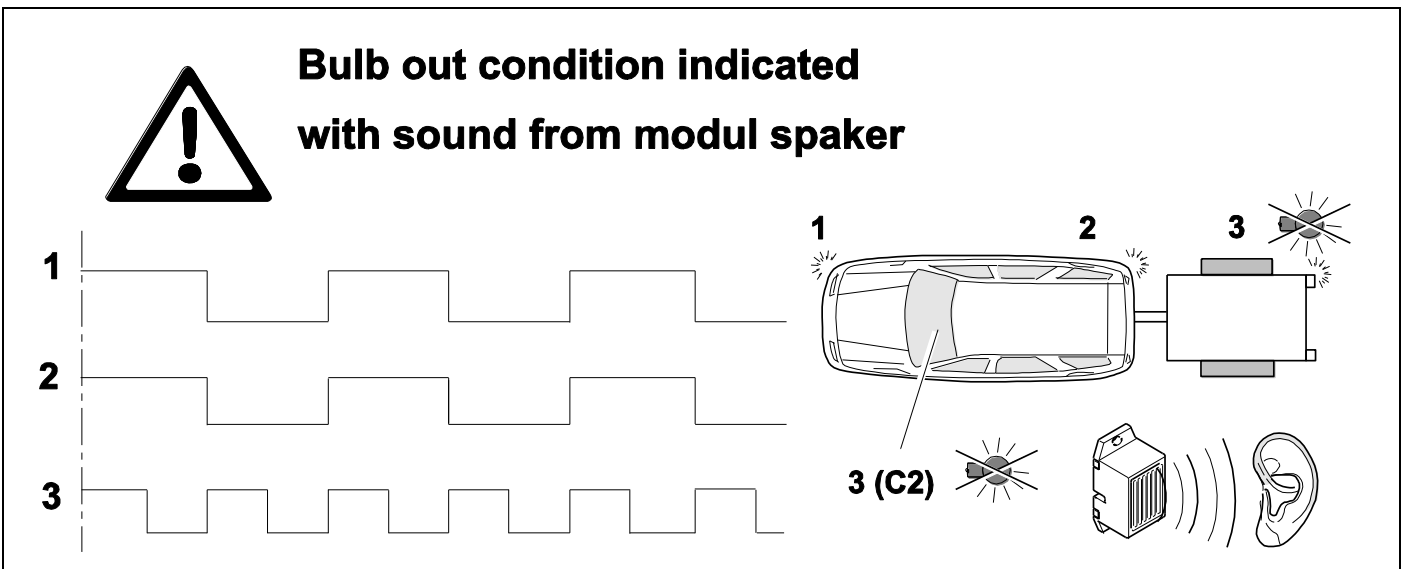

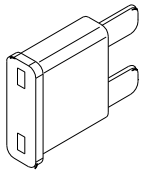

20 A

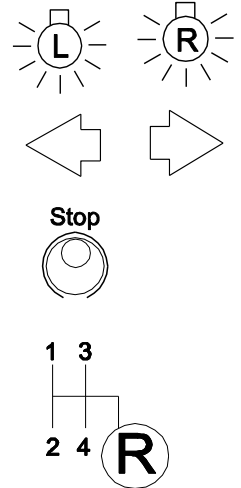
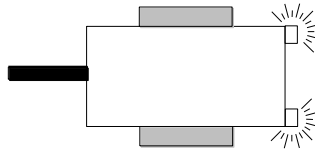

CODING OPTIONAL - SKIP THESE STEPS IF CODING OF THE VEHICLE IS NOT PLANNED

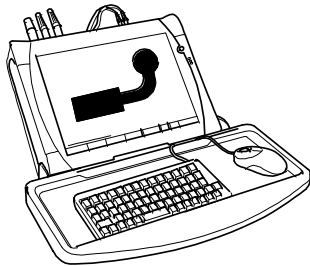

With vehicle coding



41 ⇒ 44

TSP
Trailer
Stability
Program

! Attention !

These codings may be lost

after visiting an authorized workshop!

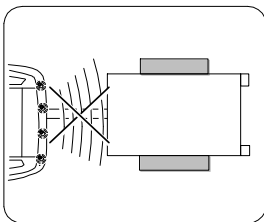

P
Trailer
Assistent



Unless you have your own coding tool and are experienced with coding VW vehicles, do not attempt coding.
DO NOT take it to an VW dealer to code. They can only code their own factory kits as it requires a special one-use only unlocking code.

41

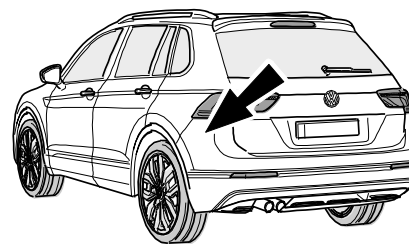
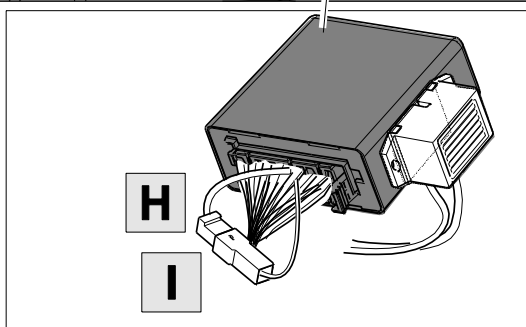
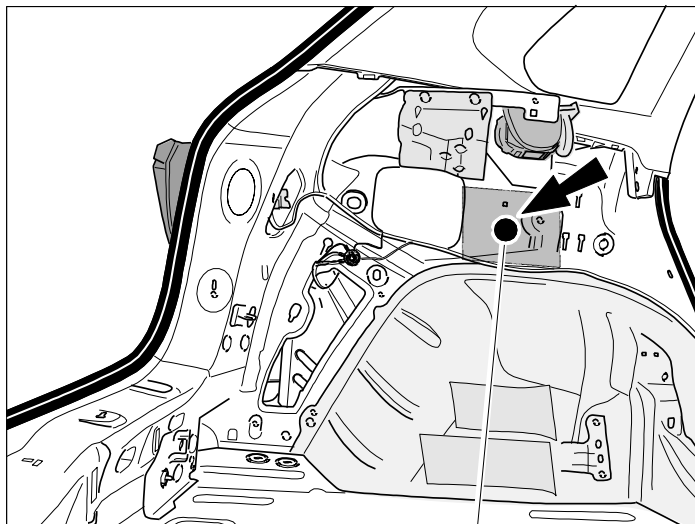

DO NOT disconnect unless coding is planned for this vehicle as errors will appear on the vehicle dash.

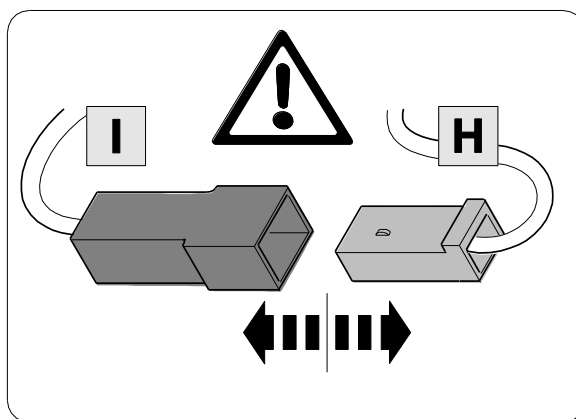

42

OPTION vehicle coding

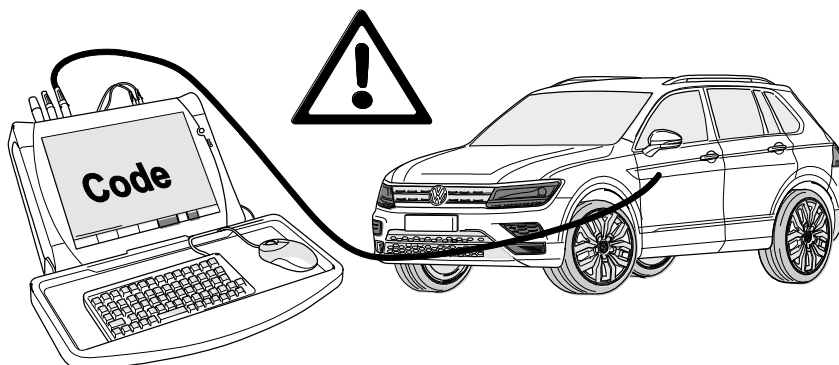

GB

For activation of the trailer function, the coding capability should be clarified / confirmed with the respective manufacturer of diagnostic coding system.

Possible diagnosis systems (local / offline):

- VCDS
- Hella Gutmann
- SP Diagnostic
- Westfalia Auto Code

If the Deactivation Loop as shown in step 41 has been disconnected in error, reconnect the loop and cycle the vehicle ignition twice to clear the error codes.

CHECK BULB OUT DETECTION

BULB OUT CONDITION INDICATED WITH INCREASED INDICATOR FREQUENCY

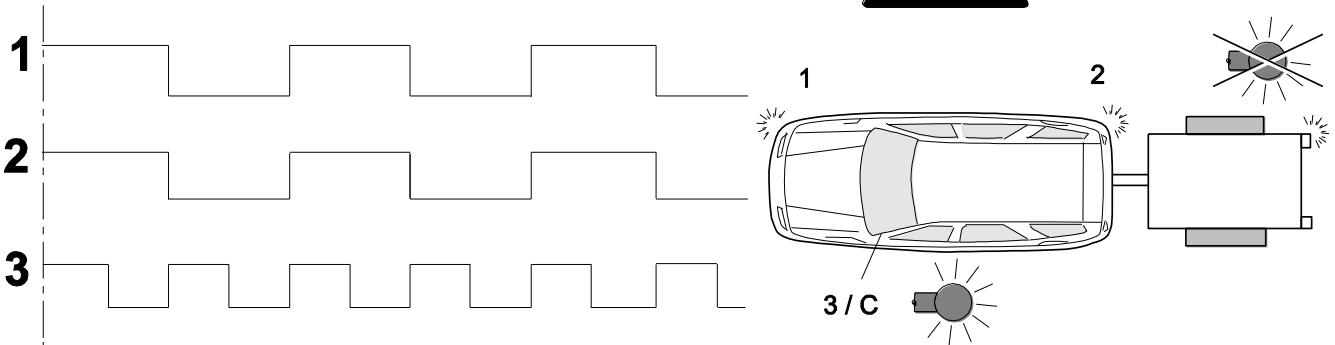

Service

Diagnostic Trouble Module: Refer to the E-Kit fitting instruction

2x 12



Service

Diagnostic Trouble Module: Refer to the E-Kit fitting instruction

Service

Diagnostic Trouble Module: Refer to the E-Kit fitting instruction

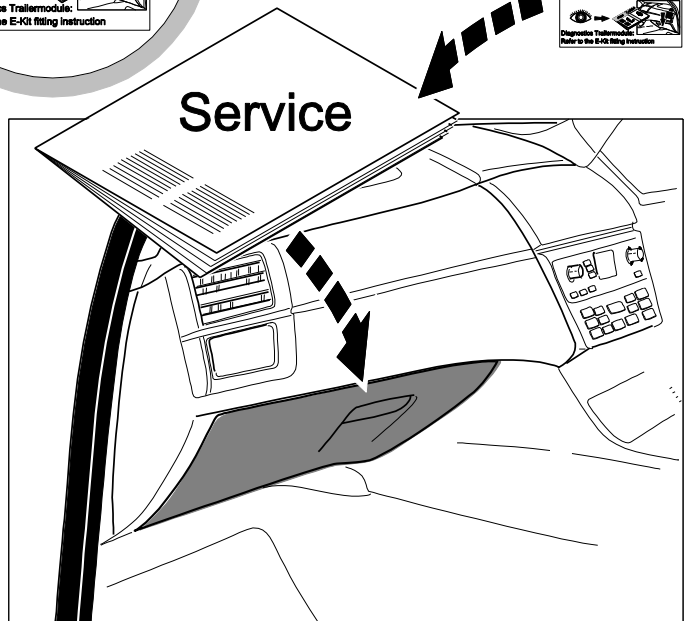
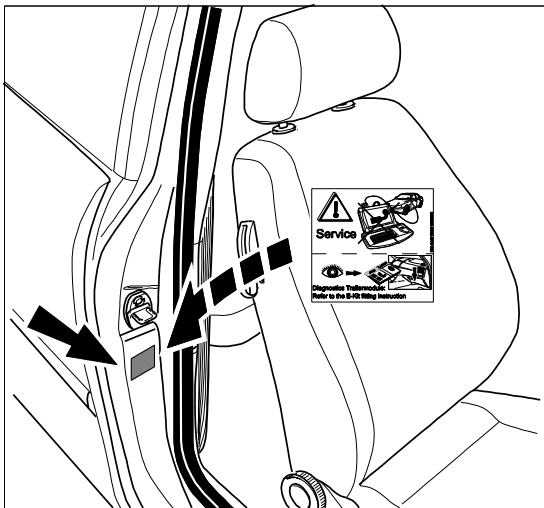

Status LED for self-diagnosis

Operation Support

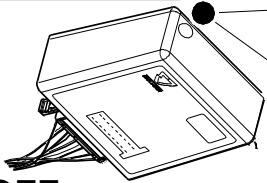
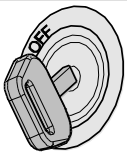

No CAN-Data =



Standby / Sleepmode



Ignition OFF

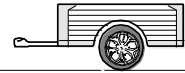
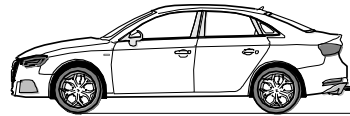
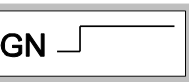
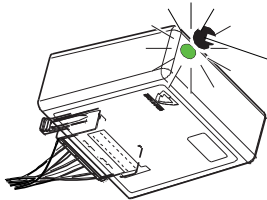

Ignition ON

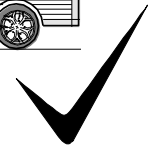
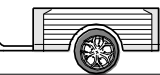
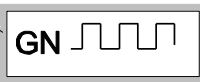
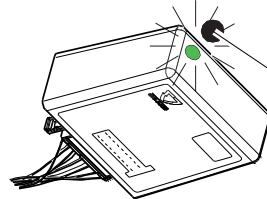

Ignition ON

Failure Support

CAN-Data Wire



1x max. 5 min.

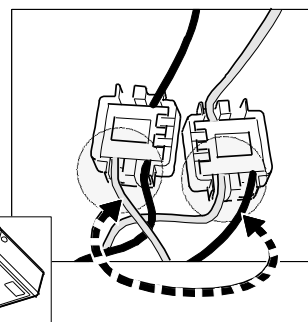
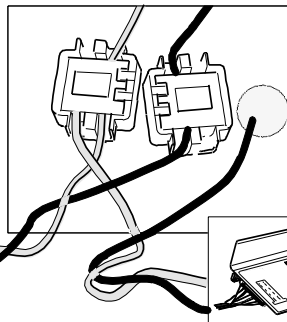
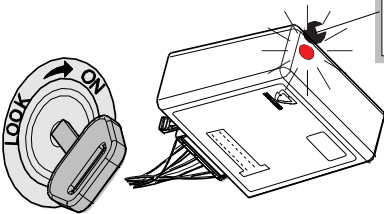

Ignition ON

Failure indicated by the module LED glowing red for a maximum of 5 minutes. If trailer connected the tail lights will also glow indicating failure of CAN signal.

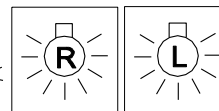

Ignition ON

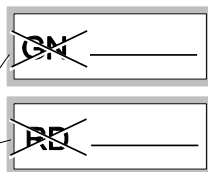
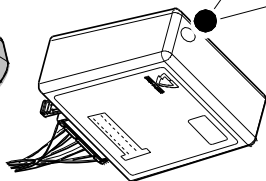

or

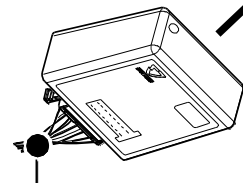
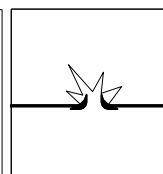
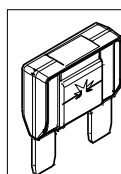
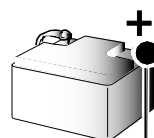
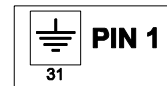

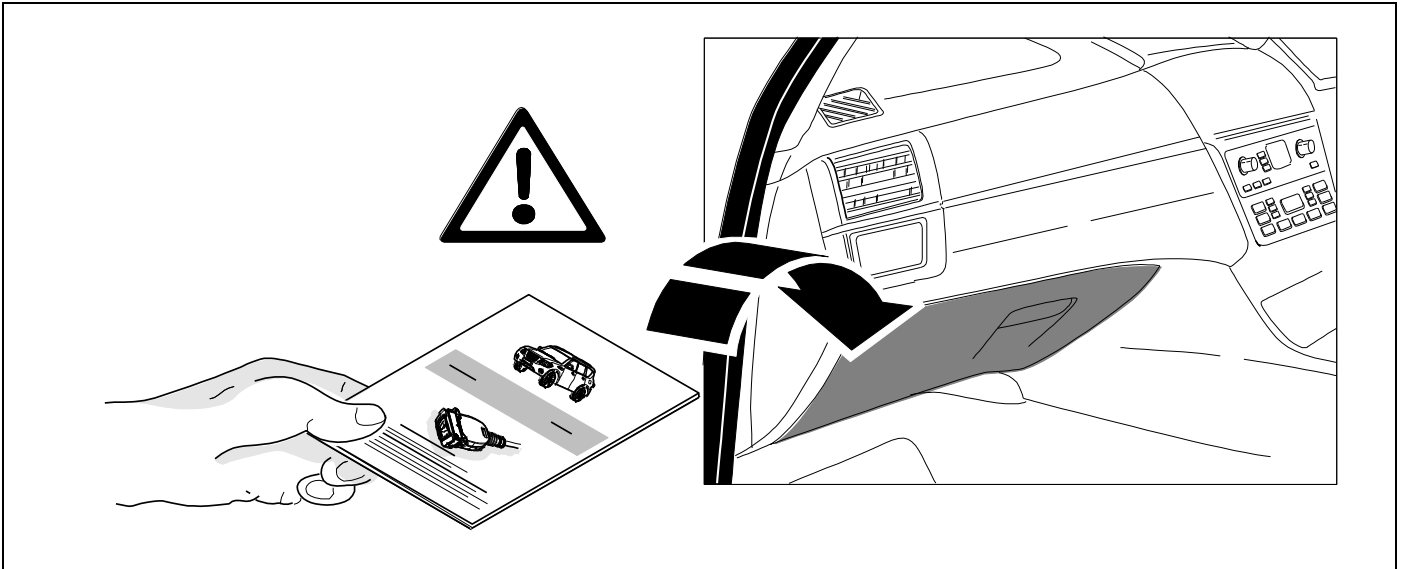

Subject to change in terms of construction, equipment and colour, and may contain errors.
The information and illustrations are non-binding.

Scan this to download
instructions for other models

